

# Panels, Fillers & Decorative Items

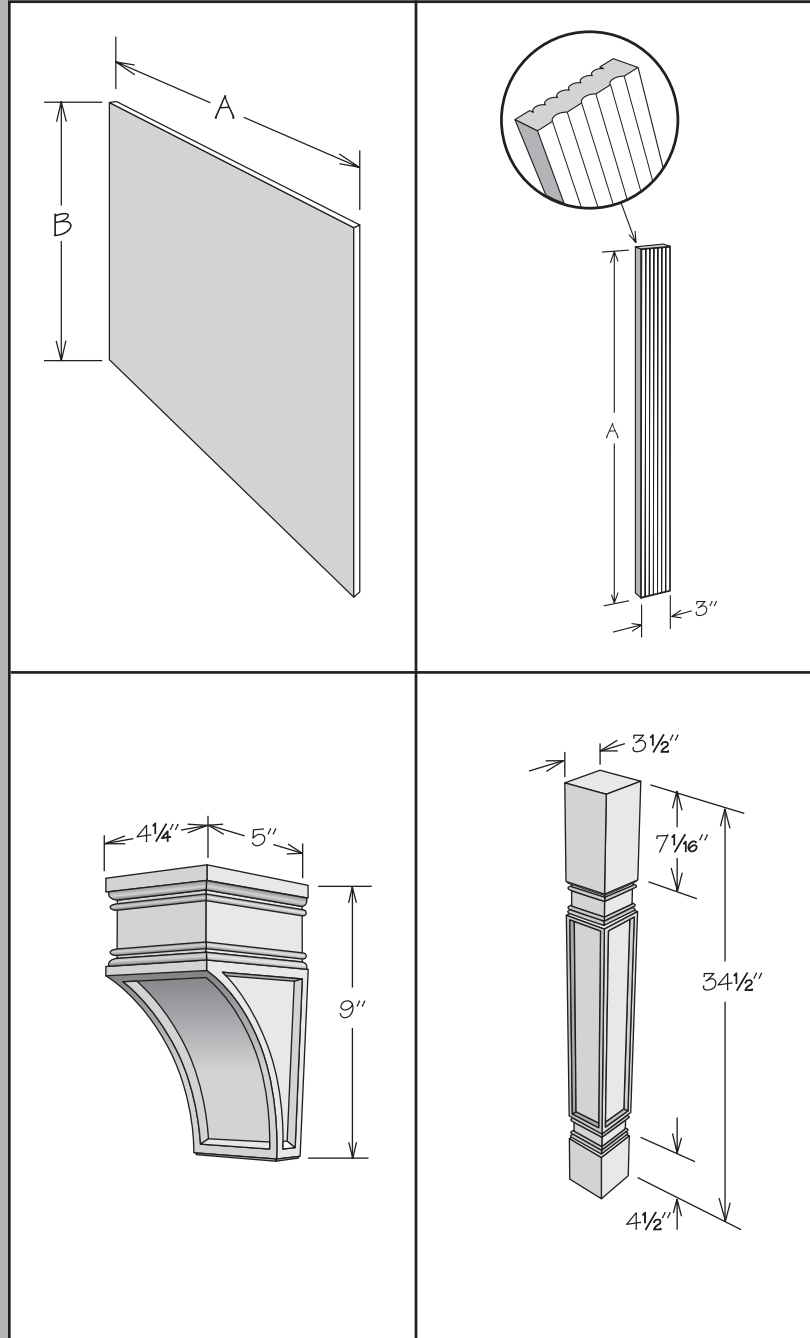

Panels

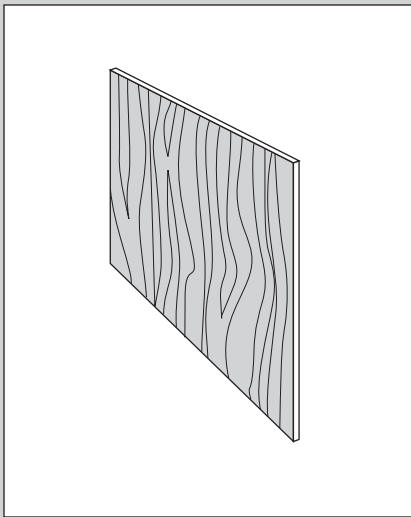

Desk End Panel

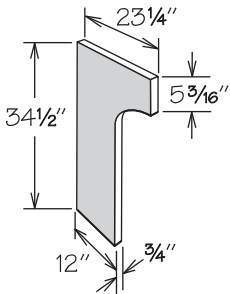

DEP
-----

- Features 3/4" engineered wood with TuffTech finish - both sides finished to match cabinet exterior
- Recommend QM8 WD be ordered for installation to ensure proper attachment to wall
- Edge banded on front
- Field trimmable

Dishwasher Return

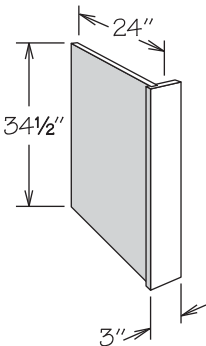

DWR3	APC
	FE
	PE

- Reversible for left or right installation
- Solid wood front
- Features 1/2" engineered wood with TuffTech finish - outside to match cabinet exterior and inside with a natural woodgrain look
- Attaching blocks included
- Field trimmable to 1" in width
- Can be notched for toe kick in the field

Sink/Vanity Front Return

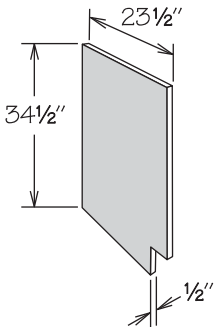

SFRR	APC
SFRL	FE
	PE

- Features 1/2" engineered wood with TuffTech finish - outside to match cabinet exterior and inside with a natural woodgrain look
- SKU signifies left or right return
- Attaching blocks included
- When ordered with Furniture Ends Option (FE) return will feature a rabbeted front edge
- Field trimmable

Sink/Vanity Front Floor

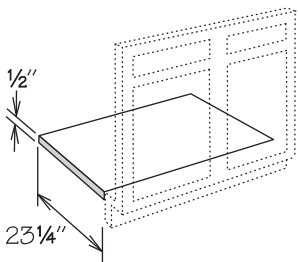

FL24	FL60
FL36	FL72
FL36X36	
FL48	
FL48X48	

- Features 1/2" engineered wood with TuffTech finish - one side finished with a natural woodgrain look
- 1/2" oversize in width
- FL36X36 to be used for CSF36 (trim to fit)
- FL48X48 to be used for CSF42 (trim to fit)
- Field trimmable

### End Panel

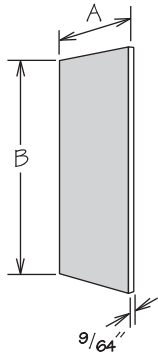

	A	B
WEP30	11¼"	30¾"
WEP42	11¼"	42⅝"
WEP48	11¼"	48"
WEP1542	14¼"	42⅝"
BEP34	23¼"	34½"
TEP84	23¼"	84"
TEP96	23¼"	96"
TEP120	23¼"	120"

WEP30  
WEP42  
WEP48  
WEP1542  
BEP34  
TEP84  
TEP96  
TEP120

- Features plywood or engineered wood finished on one side to match cabinet box exterior
- Field trimmable, can be notched for toe kick

### End Panel Duraform Textured

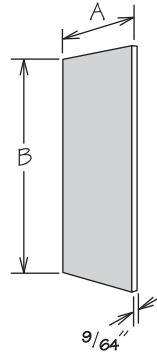

	A	B
WEP30 DT	11¼"	30¾"
WEP42 DT	11¼"	42⅝"
WEP48 DT	11¼"	48"
WEP1542 DT	14¼"	42⅝"
BEP34 DT	23¼"	34½"
TEP84 DT	23¼"	84"
TEP96 DT	23¼"	96"
TEP120 DT	23¼"	120"

WEP30 DT  
WEP42 DT  
WEP48 DT  
WEP1542 DT  
BEP34 DT  
TEP84 DT  
TEP96 DT  
TEP120 DT

- Available for Breeze, Cascade and Drift finishes only
- Features textured PVC-wrapped engineered wood finished on one side to match cabinet door
- Field trimmable, can be notched for toe kick

### Grooved End Panel

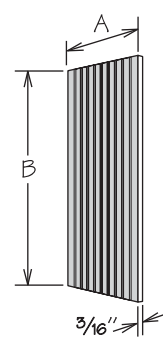

	A	B
WEP30 GROOVED	11¼"	30¾"
WEP42 GROOVED	11¼"	42⅝"
WEP48 GROOVED	11¼"	48"
WEP1542 GROOVED	14¼"	42⅝"
BEP34 GROOVED	23¼"	34½"
TEP84 GROOVED	23¼"	84"
TEP96 GROOVED	23¼"	96"

WEP30 GROOVED  
WEP42 GROOVED  
WEP48 GROOVED  
WEP1542 GROOVED  
BEP34 GROOVED  
TEP84 GROOVED  
TEP96 GROOVED

- Grooved every 1½" on one side
- Features ⅜" plywood finished to match cabinet box exterior on one side
- Grooves are beaded to complement the Cottage door style
- Field trimmable, can be notched for toe kick

**Finished Paneling**

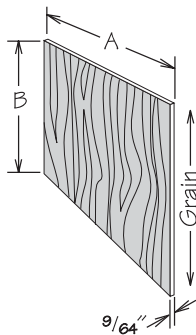

	A	B
FP4834	48"	34½"
FP4896	48"	96"
FP9634	96"	34½"
FP9648	96"	48"

FP4834  
FP4896  
FP9634  
FP9648

- Features plywood or engineered wood finished on one side to match cabinet box exterior
- Field trimmable, can be notched for toe kick

**Finished Paneling  
Duraform Textured**

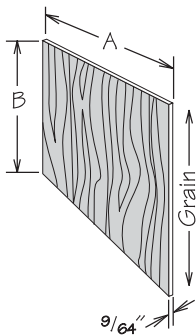

	A	B
FP4834 DT	48"	34½"
FP4896 DT	48"	96"
FP9634 DT	96"	34½"

FP4834 DT  
FP4896 DT  
FP9634 DT

- Available for Breeze, Cascade and Drift finishes only
- Features textured PVC-wrapped engineered wood finished on one side to match cabinet door
- FP9634 DT is shipped as two 48" wide x 34½" high panels
- Field trimmable, can be notched for toe kick

**Grooved Finished Paneling**

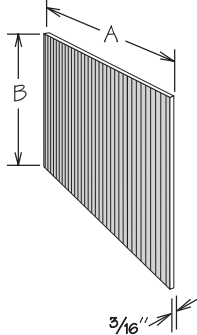

	A	B
FP4834 GROOVED	48"	34½"
FP4896 GROOVED	48"	96"
FP9634 GROOVED	96"	34½"

FP4834 GROOVED  
FP4896 GROOVED  
FP9634 GROOVED

- Grooved every 1½" on one side
- Features ¾" plywood finished to match cabinet box exterior on one side
- FP9634 GROOVED is shipped as two 48" wide x 34½" high panels
- Grooves are beaded to complement the Cottage door style
- Field trimmable, can be notched for toe kick

**Wood End Panel  
Duraform Textured**

	A	B
WWEP1330 DT	30⅞"	13"
WWEP1336 DT	36⅞"	13"
WWEP1339 DT	39⅞"	13"
WWEP1342 DT	42⅞"	13"
WBEP2534 DT	34½"	25"
DWTEP84 DT	84"	32"
DWTEP96 DT	96"	32"
DWTEP120 DT	120"	32"

WWEP1330 DT  
WWEP1336 DT  
WWEP1339 DT  
WWEP1342 DT  
WBEP2534 DT  
DWTEP84 DT  
DWTEP96 DT  
DWTEP120 DT

- Available for Breeze, Cascade and Drift finishes only
- Features textured PVC-wrapped engineered wood finished on both sides to match cabinet door
- WBEP\_DT and DWTEP\_DT are edge banded on both long sides
- WWEP\_DT is edge banded on all four sides
- Field trimmable, can be notched for toe kick

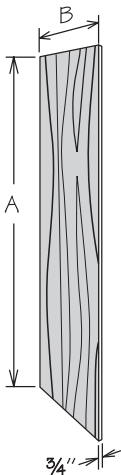

**Wood Base End Panel**

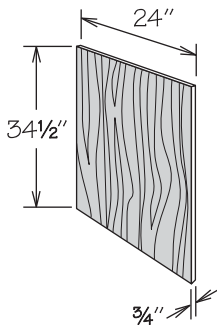

WBEP

- Engineered wood finished to match cabinet box exterior on both sides
- Edge banded on both long edges
- Field trimmable, can be notched for toe kick

**Wood Tall End Panel**

	A	B
WTEP84	84"	24"
WTEP96	96"	24"
WTEP120	120"	24"
DWTEP84	84"	32"
DWTEP96	96"	32"

WTEP84  
WTEP96  
WTEP120  
DWTEP84  
DWTEP96

- Engineered wood finished to match cabinet box exterior on both sides
- Edge banded on both long edges
- Field trimmable, can be notched for toe kick

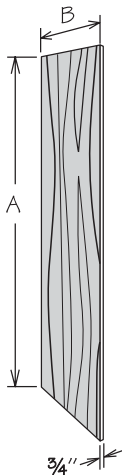

### Refrigerator Return

24" Deep, 1/2" Panel

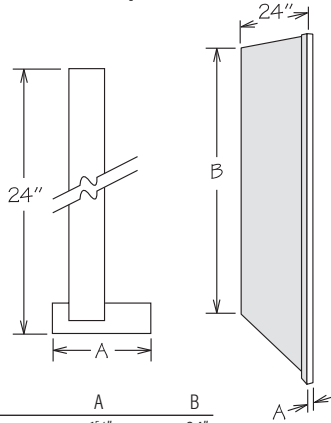

	A	B
RR84	1 1/8"	84"
RR384	3"	84"
RR96	1 1/8"	96"
RR396	3"	96"

RR84	RR384	APC
RR96	RR396	FE
		MI
		PE

- Reversible for left or right installation
- Solid wood front
- Features 1/2" engineered wood with TuffTech finish - outside finished to match cabinet exterior and inside with a natural woodgrain look
- Field trimmable, can be notched for toe kick

### Refrigerator Return

32" Deep, 1/2" Panel

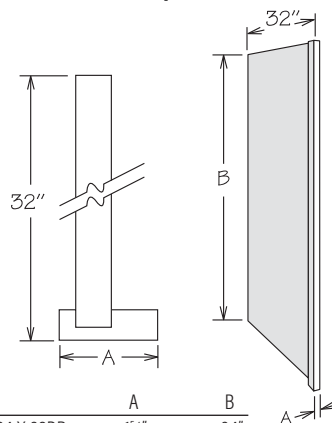

	A	B
RR84 X 32DP	1 1/8"	84"
RR384 X 32DP	3"	84"
RR96 X 32DP	1 1/8"	96"
RR396 X 32DP	3"	96"

RR84 X 32DP	RR384 X 32DP	FE
RR96 X 32DP	RR396 X 32DP	MI
		RD

- Reversible for left or right installation
- Solid wood front
- Features 1/2" plywood finished on outside to match cabinet exterior and TuffTech natural woodgrain look on inside
- Field trimmable, can be notched for toe kick

### Refrigerator Return

24" Deep, 3/4" Panel

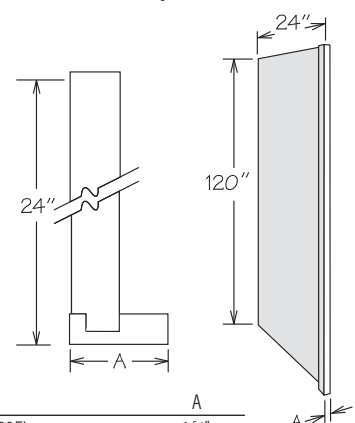

	A
RR120FL	1 1/8"
RR3120FL	3"

RR120FL	APC
RR3120FL	

- Reversible for left or right installation
- Solid wood front
- Features 3/4" engineered wood with TuffTech finish - both sides finished to match cabinet exterior
- Field trimmable, can be notched for toe kick

### Refrigerator Return

32" Deep, 3/4" Panel

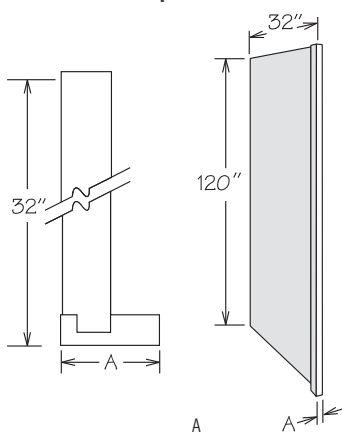

	A
RR120FL X 32DP	1 1/8"
RR3120FL X 32DP	3"

RR120FL X 32DP	RD
RR3120FL X 32DP	

- Reversible for left or right installation
- Solid wood front
- Features 3/4" plywood finished to match cabinet box exterior on both sides
- Field trimmable, can be notched for toe kick

### Floating Shelf

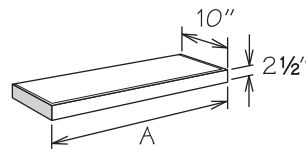

	A	Max. Load
FLSH2410	24"	30 lbs.
FLSH3010	30"	37 lbs.
FLSH3610	36"	45 lbs.
FLSH4210	42"	52 lbs.
FLSH4810	48"	60 lbs.

FLSH2410  
FLSH3010  
FLSH3610  
FLSH4210  
FLSH4810

- Not trimmable
- Finished on all sides to match cabinet box exterior
- Features veneered engineered wood top and bottom and solid wood front and sides
- When installed between two cabinets, Furniture Ends (FE) is recommended for adjacent cabinets
- Must be secured to studs in wall
- Installation instructions, mounting brackets and screws included

Finished Shelf

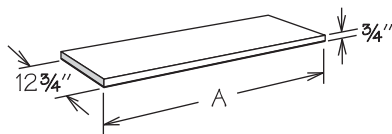

	A
FS4812	48 1/4"
FS6012	60 1/4"
FS7212	72 1/4"

FS4812  
FS6012  
FS7212

- Field trimmable
- Veneered engineered wood, edge banded all sides
- Finished to match cabinet box exterior

Finished Shelf  
Duraform Textured

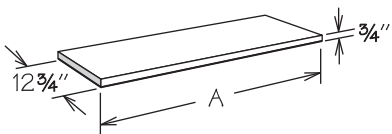

	A
FS4812 DT	48 1/4"
FS6012 DT	60 1/4"
FS7212 DT	72 1/4"

FS4812 DT  
FS6012 DT  
FS7212 DT

- Available for Breeze, Cascade and Drift finishes only
- Field trimmable
- Features textured PVC-wrapped engineered wood finished on both sides to match cabinet door
- Edge banded on all sides

Blind Corner Closure

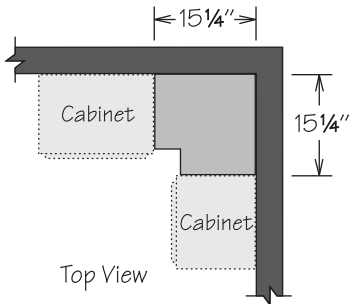
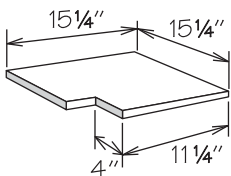

BLC1515

- Features 1/2" engineered wood with TuffTech finish - both sides finished with a natural woodgrain look
- Field trimmable

Toe Kicks

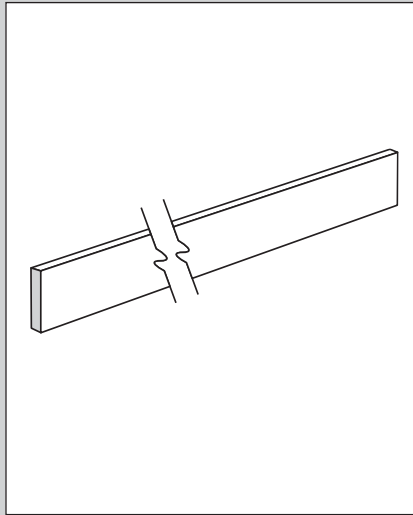

Base Toe Kick

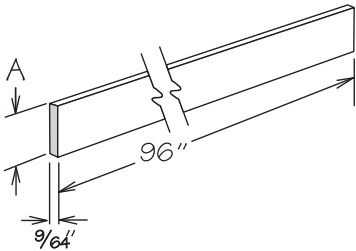

	A
BTK8	3 15/16"
BTK8 UD	8"

BTK8  
BTK8 UD

- Features plywood or engineered wood finished on one side to match cabinet box exterior
- Putty Stick and TU Marker are recommended for exposed ends

Base Toe Kick  
Duraform Textured

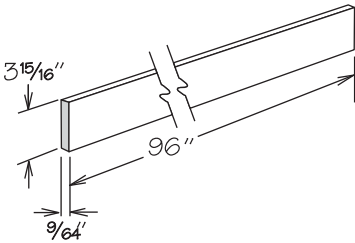

BTK8 DT

- Available for Breeze, Cascade and Drift finishes only
- Features textured PVC-wrapped engineered wood finished on one side to match cabinet door
- Putty Stick and TU Marker are recommended for exposed ends

This image shows a single sheet of white paper with horizontal ruling lines. The lines are evenly spaced and run across the width of the page. There are no margins, text, or other markings on the paper.

**Decorator Matching Doors**

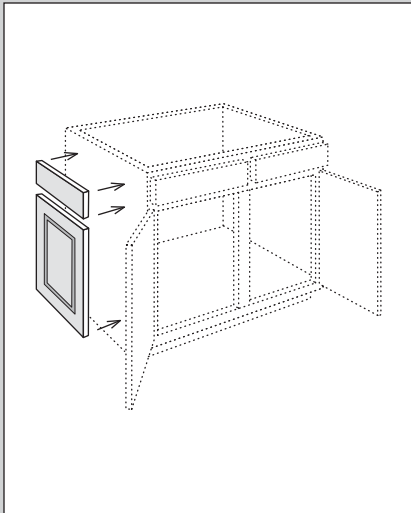

Decorator Matching Doors are not sized for Reduced Depth (RD) or Increased Depth (ID) cabinets.

**Decorator Matching Doors  
Tall Cabinets**

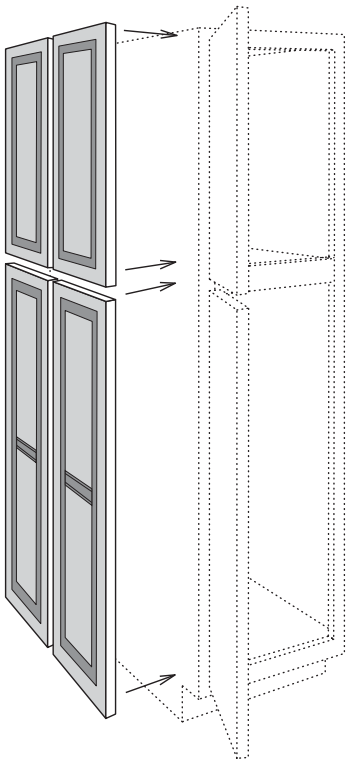

DMDT8412  
DMDT8424  
DMDT9012  
DMDT9024  
DMDT9312  
DMDT9324  
DMDT9612  
DMDT9624

- Furniture Ends Option (FE) or TEP84/TEP96 panel is required for installation
- Attaches to side of Utility or Oven cabinet
- Matches style and finish of cabinet doors
- 24" deep features four doors (as shown)
- 12" deep features two doors
- DMDT bottom doors will have a center rail with the exception of Irvington, Sydney, Warren, Warren w/ DFO and Duraform door styles
- Refer to the Parts Directory section of this guide for dimensions

**Decorator Matching Doors  
Base Cabinets**

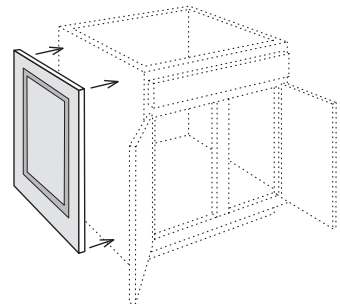

DMDB

- Furniture Ends Option (FE) or BEP34 panel is required for installation
- Attaches to side of Base cabinet
- Matches style and finish of cabinet doors
- Refer to the Parts Directory section of this guide for dimensions

**Decorator Matching Doors  
BEA12FH Base Cabinets**

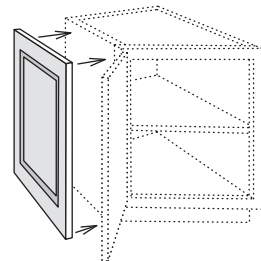

DMDBEA12

- Furniture Ends Option (FE) or WEP42 panel is required for installation
- Attaches to side of BEA12FH or BSPLY2434
- Matches style and finish of cabinet doors
- Refer to the Parts Directory section of this guide for dimensions



### Decorator Matching Doors Desk Cabinets

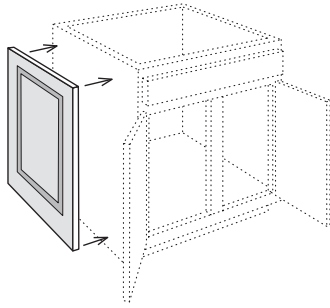

DMDD21  
DMDD24

- Furniture Ends Option (FE) or BEP34 panel is required for installation
- Attaches to side of 21" or 24" deep Desk cabinet
- Matches style and finish of cabinet doors
- Refer to the Parts Directory section of this guide for dimensions

### Decorator Matching Doors Vanity Cabinets

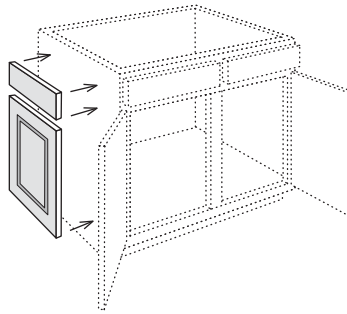

DMDV

- Furniture Ends Option (FE) or BEP34 panel is required for installation
- Attaches to side of 20 3/4" deep x 31 1/2" high Vanity cabinet
- For 18" deep x 31 1/2" high vanity cabinets order DR1821 ND and DDF18
- For base-height vanity cabinets order DR21FH ND door for 20 3/4" deep or DR18FH ND door for 18" deep cabinets
- Matches style and finish of cabinet doors
- Refer to the Parts Directory section of this guide for dimensions

### Decorator Matching Doors Wall Cabinets

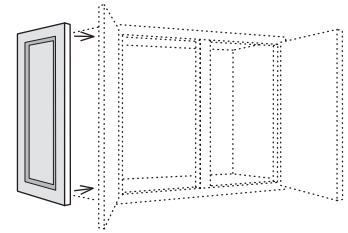

DMDW18  
DMDW24  
DMDW30  
DMDW36  
DMDW39  
DMDW42

- Furniture Ends Option (FE) or WEP30/WEP42 panel is required for installation
- Attaches to side of wall cabinet
- Matches style and finish of cabinet doors
- Refer to the Parts Directory section of this guide for dimensions

Fillers

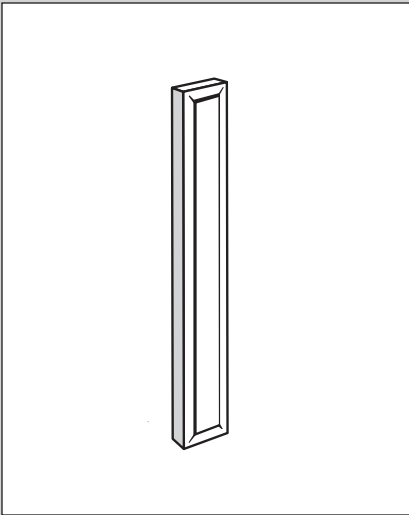

To facilitate proper door operation, include at least a 1" filler between the hinged side of Full Overlay door styles and deeper adjacent objects including cabinets, walls, appliances and countertops.

Universal Filler

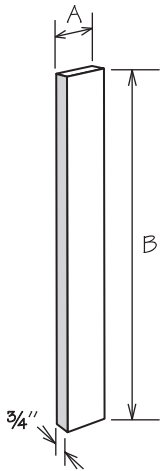

	A	B
UF3	3"	30 1/2"
UF6	6"	30 1/2"
UF342	3"	42 1/8"
UF642	6"	42 1/8"
UF380	3"	80"
UF680	6"	80"
UF392	3"	92"
UF692	6"	92"
UF3120	3"	120"

UF3	UF6
UF342	UF642
UF380	UF680
UF392	UF692
UF3120	

- 3/4" solid wood
- Finished on front and all four edges to match cabinet box exterior
- Field trimmable

Universal Filler Extension

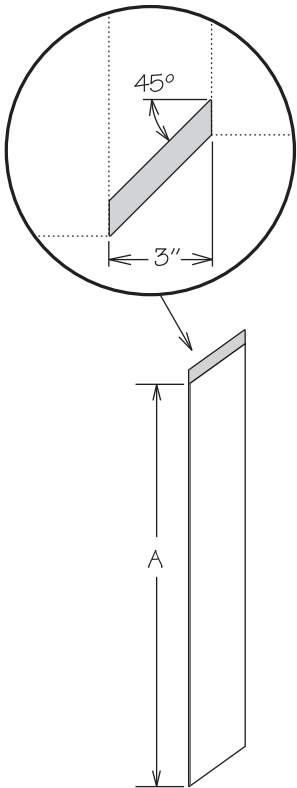

	A
UF E3	30 1/2"
UF E342	42 1/8"

UF E3  
UF E342

- For wall or base application
- 3/4" solid wood
- Finished on front and all four edges to match cabinet box exterior
- Field trimmable

### 3" Overlay Filler

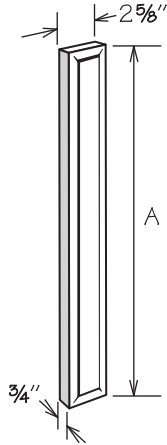

	A
BOF3	29 1/8"
DOF3	23 3/8"
TOF384	79 3/8"
TOF390	85 3/8"
TOF393	88 3/8"
TOF396	91 3/8"
VOF3	26 1/2"
WOF312	11 1/8"
WOF315	14 3/8"
WOF318	17 1/8"
WOF321	20"
WOF324	23 1/8"
WOF327	26 1/2"
WOF330	29 1/2"
WOF336	35 1/2"
WOF339	38 1/2"
WOF342	41 1/2"

BOF3	WOF312
	WOF315
DOF3	WOF318
	WOF321
TOF384	WOF324
TOF390	WOF327
TOF393	WOF330
TOF396	WOF336
	WOF339
VOF3	WOF342

- For Full Overlay door styles only
- Outside profile matches door
- Wood, Painted and Duraform (Breeze, Cascade, Drift) door styles feature solid wood finished to match cabinet box exterior
- Duraform (Linen, Silk, Stone) door styles feature Duraform wrapped MDF
- All edges are finished
- Not field trimmable
- Must be mounted to a Universal Filler – order separately

### 3" Overlay Filler Duraform Textured

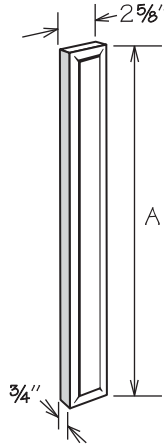

	A
BOF3 DT	29 1/8"
DOF3 DT	23 3/8"
TOF384 DT	79 3/8"
TOF390 DT	85 3/8"
TOF393 DT	88 3/8"
TOF396 DT	91 3/8"
VOF3 DT	26 1/2"
WOF312 DT	11 1/8"
WOF315 DT	14 3/8"
WOF318 DT	17 1/8"
WOF321 DT	20"
WOF324 DT	23 1/8"
WOF327 DT	26 1/2"
WOF330 DT	29 1/2"
WOF336 DT	35 1/2"
WOF339 DT	38 1/2"
WOF342 DT	41 1/2"

BOF3 DT	WOF312 DT
	WOF315 DT
DOF3 DT	WOF318 DT
	WOF321 DT
TOF384 DT	WOF324 DT
TOF390 DT	WOF327 DT
TOF393 DT	WOF330 DT
TOF396 DT	WOF336 DT
	WOF339 DT
VOF3 DT	WOF342 DT

- Available for Breeze, Cascade and Drift finishes only
- Outside profile matches door
- Features textured PVC-wrapped engineered wood finished to match cabinet door
- All edges are finished
- Not field trimmable
- Must be mounted to a Universal Filler – order separately

### 6" Overlay Filler

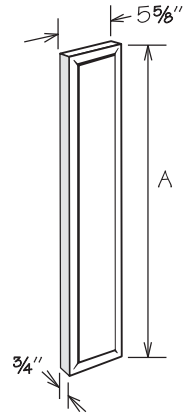

	A
WOF630	29 1/2"
WOF636	35 1/2"
WOF639	38 1/2"
WOF642	41 1/2"

WOF630  
WOF636  
WOF639  
WOF642

- For Full Overlay Duraform (Linen, Silk, Stone) door styles only
- Outside profile matches door
- All edges are finished to match cabinet box exterior
- Features Duraform wrapped MDF
- Not field trimmable
- Must be mounted to a Universal Filler – order separately

### Base Corner Filler

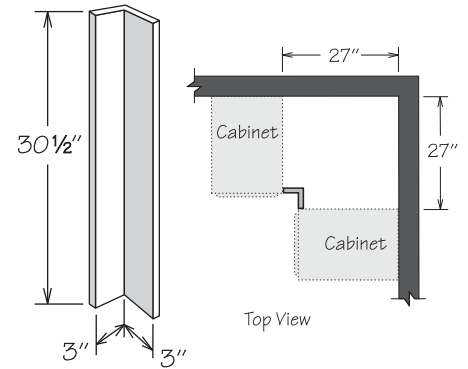

BCF27

- 3/4" solid wood
- Finished on front and all four edges to match cabinet box exterior
- Field trimmable

Fluted Beaded Filler

Reversible - 3" Wide

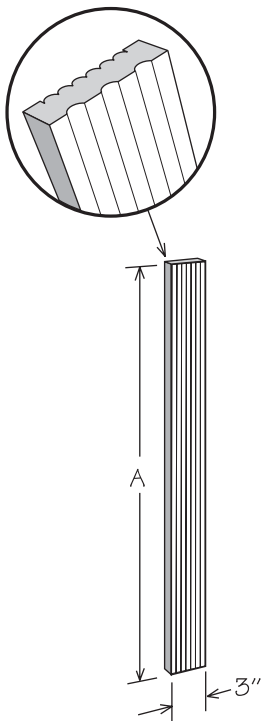

	A
FBF3	30½"
FBF342	42⅞"
FBF384	84"
FBF396	96"

FBF3  
FBF342  
FBF384  
FBF396

- Filler is fluted on one side and beaded on reverse side
- Finished on all sides to match cabinet box exterior
- Field trimmable
- ¾" solid wood
- Apply 3" wide decorative blocks for accent
- Designer note: Ensure correct side is exposed when installed

Fluted Beaded Filler

Reversible - 6" Wide

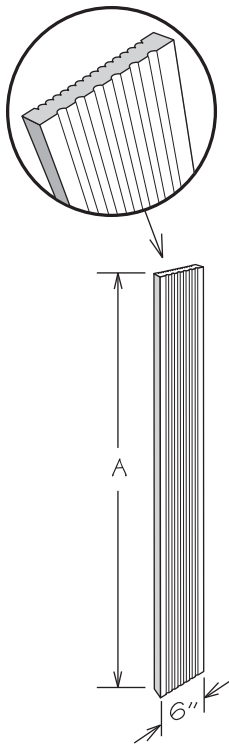

	A
FBF6	30½"
FBF642	42⅞"
FBF684	84"
FBF696	96"

FBF6  
FBF642  
FBF684  
FBF696

- Filler is fluted on one side and beaded on reverse side
- Finished on all sides to match cabinet box exterior
- Field trimmable
- ¾" solid wood
- Apply 6" wide decorative blocks for accent
- Designer note: Ensure correct side is exposed when installed

Fluted Beaded Filler Extension

Reversible

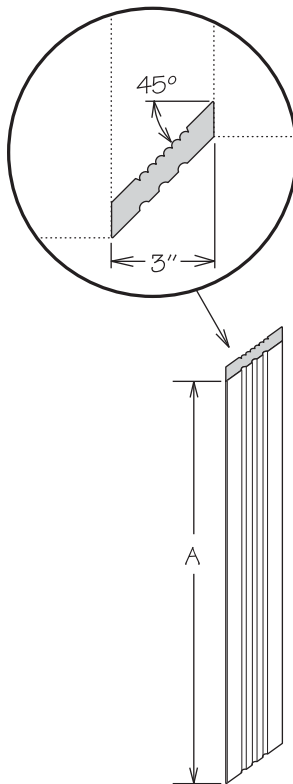

	A
FBF E3	30½"
FBF E342	42⅞"

FBF E3  
FBF E342

- For wall or base application
- Filler is fluted on one side and beaded on reverse side
- Finished on all sides to match cabinet box exterior
- Field trimmable
- ¾" solid wood
- Apply 3" wide decorative blocks for accent
- Designer note: Ensure correct side is exposed when installed

### Wall Column Filler

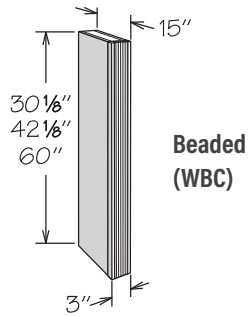

**Beaded  
(WBC)**

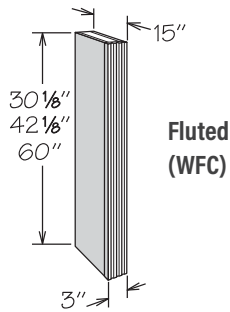

**Fluted  
(WFC)**

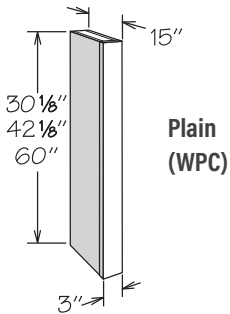

**Plain  
(WPC)**

WBC31530  
WBC31542  
WBC31560  
WFC31530  
WFC31542  
WFC31560  
WPC31530  
WPC31542  
WPC31560

- 3" wide x 3/4" thick solid wood front
- Finished veneered engineered wood sides are flush with face
- Reversible for left or right installation
- Top and bottom edges of returns are edge banded to match cabinet box exterior
- Field trimmable to any depth
- Field trimmable in height as noted below:
  - W\_C31530 field trimmable to 27", 24 1/2", 20 3/8", 18 1/8", 15 1/4" or 12 1/2"
  - W\_C31542 field trimmable to 36 1/8" or 39 1/8"
  - W\_C31560 field trimmable to 48" or 54"

### Base Column Filler

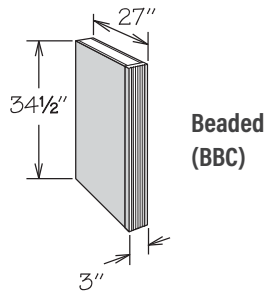

**Beaded  
(BBC)**

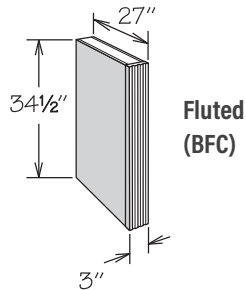

**Fluted  
(BFC)**

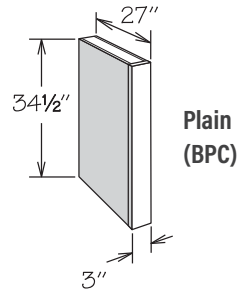

**Plain  
(BPC)**

BBC32734  
BFC32734  
BPC32734

- 3" wide x 3/4" thick solid wood front
- Finished veneered engineered wood sides are flush with face
- Reversible for left or right installation
- Top and bottom edges of returns are edge banded to match cabinet box exterior
- Field trimmable to any depth
- Field trimmable in height as noted below:
  - B\_C32734 field trimmable to 31 1/2" or 28 1/2"

### Tall Column Filler

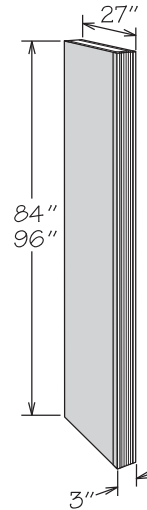

**Beaded  
(TBC)**

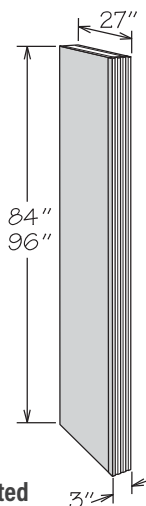

**Fluted  
(TFC)**

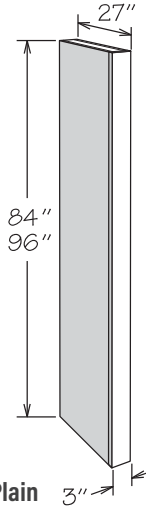

**Plain  
(TPC)**

TBC32784  
TBC32796  
TFC32784  
TFC32796  
TPC32784  
TPC32796

- 3" wide x 3/4" thick solid wood front
- Finished veneered engineered wood sides are flush with face
- Reversible for left or right installation
- Top and bottom edges of returns are edge banded to match cabinet box exterior
- Field trimmable to any depth
- Field trimmable in height as noted below:
  - T\_C32796 field trimmable to 90" or 93"
  - T\_C32784 is not field trimmable in height

## Decorative Blocks

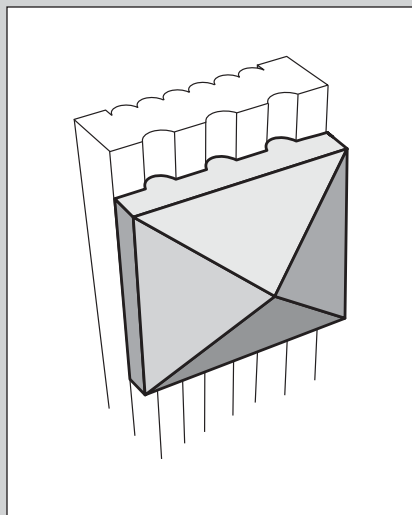

## Pyramid Block - 3"

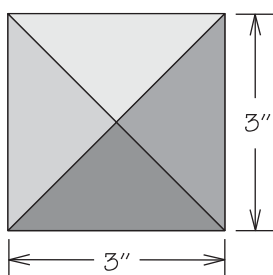

## Fluted

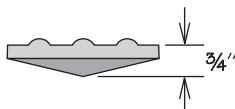
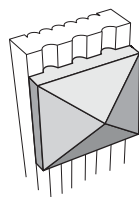

FB3X3 PYRAMID

- Apply to FLUTED side of 3" reversible filler, reversible filler extension or fluted column filler
- Solid wood finished to match cabinet box exterior

## Beaded

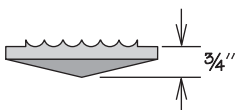
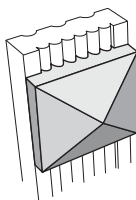

BB3X3 PYRAMID

- Apply to BEADED side of 3" reversible filler, reversible filler extension or beaded column filler
- Solid wood finished to match cabinet box exterior

## Rosette Block - 3"

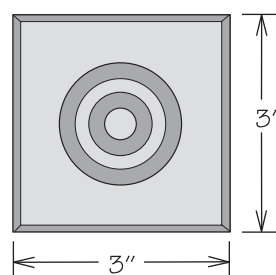

## Fluted

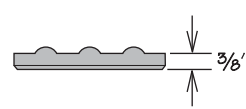
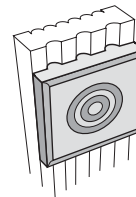

FB3X3 ROSETTE

- Apply to FLUTED side of 3" reversible filler, reversible filler extension or fluted column filler
- Solid wood finished to match cabinet box exterior

## Beaded

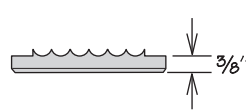
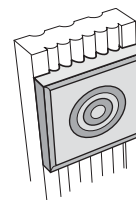

BB3X3 ROSETTE

- Apply to BEADED side of 3" reversible filler, reversible filler extension or beaded column filler
- Solid wood finished to match cabinet box exterior

**Aster Block - 3"**

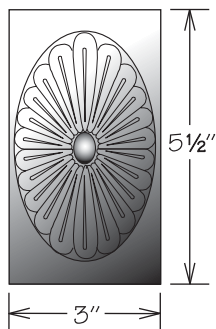

**Fluted**

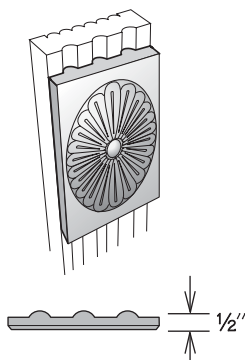

FB3X6 ASTER

- Apply to FLUTED side of 3" reversible filler, reversible filler extension or fluted column filler
- Solid wood finished to match cabinet box exterior

**Beaded**

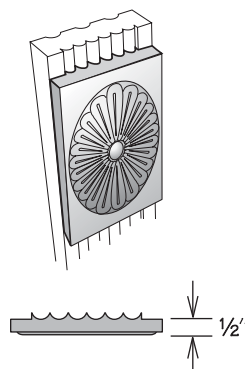

BB3X6 ASTER

- Apply to BEADED side of 3" reversible filler, reversible filler extension or beaded column filler
- Solid wood finished to match cabinet box exterior

**Plinth Block - 3"**

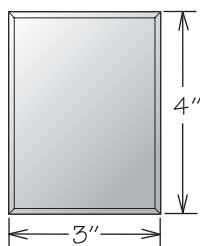

**Fluted**

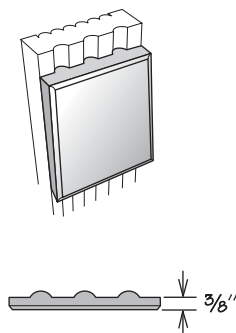

FB3X4 PLINTH

- Apply to FLUTED side of 3" reversible filler, reversible filler extension or fluted column filler
- Solid wood finished to match cabinet box exterior

**Beaded**

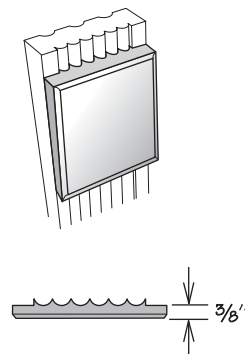

BB3X4 PLINTH

- Apply to BEADED side of 3" reversible filler, reversible filler extension or beaded column filler
- Solid wood finished to match cabinet box exterior

**Plinth Block - 6"**

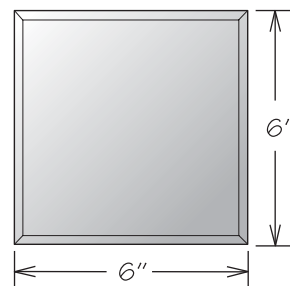

**Fluted**

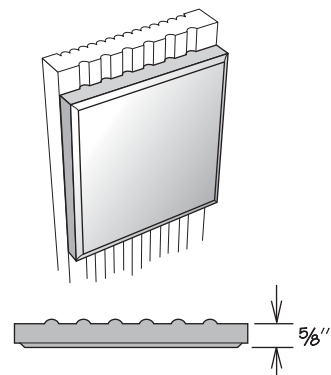

FB6X6 PLINTH

- Apply to FLUTED side of 6" reversible filler
- Solid wood finished to match cabinet box exterior

**Beaded**

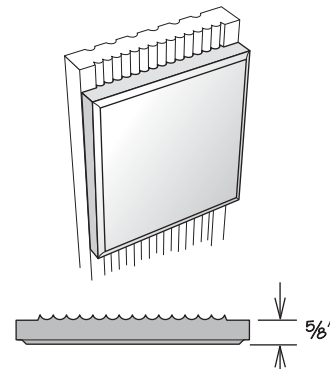

BB6X6 PLINTH

- Apply to BEADED side of 6" reversible filler
- Solid wood finished to match cabinet box exterior

Valances

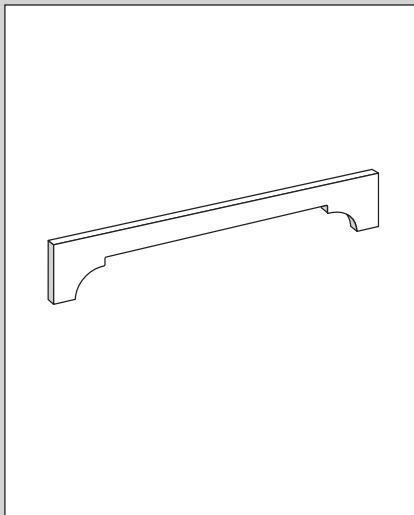

Raised Panel Arched Valance

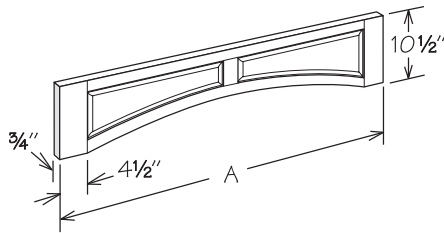

	A	Maximum Trim (3" Each End)	Number of Panels
V36 RP	36"	30"	2
V42 RP	42"	36"	2
V48 RP	48"	42"	2
V54 RP	54"	48"	3
V60 RP	60"	54"	3
V66 RP	66"	60"	3
V72 RP	72"	66"	3

V36 RP      V60 RP  
V42 RP      V66 RP  
V48 RP      V72 RP  
V54 RP

- Field trimmable
- Solid wood finished to match cabinet box exterior
- Dimension from height of arch to top of valance is 8 1/2"

Flat Panel Arched Valance

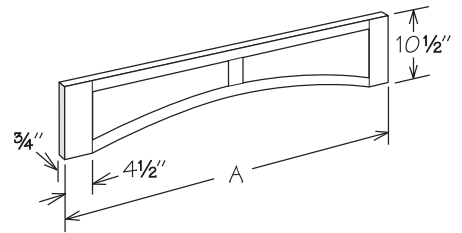

	A	Maximum Trim (3" Each End)	Number of Panels
V36 FP	36"	30"	2
V42 FP	42"	36"	2
V48 FP	48"	42"	2
V54 FP	54"	48"	3
V60 FP	60"	54"	3
V66 FP	66"	60"	3
V72 FP	72"	66"	3

V36 FP      V60 FP  
V42 FP      V66 FP  
V48 FP      V72 FP  
V54 FP

- Field trimmable
- Solid wood finished to match cabinet box exterior
- Dimension from height of arch to top of valance is 8 1/2"

Shaker Valance

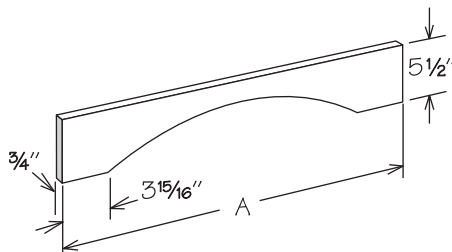

	A	Maximum Trim (3 1/2" each end)
V30 SH	30 1/4"	24"
V36 SH	36 1/4"	30"
V42 SH	42 1/4"	36"
V48 SH	48 1/4"	42"
V60 SH	60 1/4"	54"
V72 SH	72 1/4"	66"

V30 SH      V48 SH  
V36 SH      V60 SH  
V42 SH      V72 SH

- Field trimmable
- Solid wood finished to match cabinet box exterior
- Dimension from height of arch to top of valance is 2 1/4"

Arched Valance

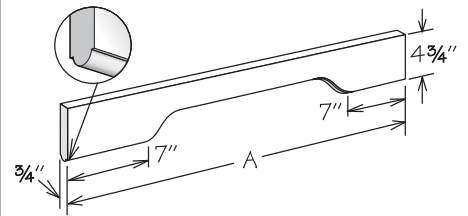

	A	Maximum Trim (6 1/2" each end)
V36 AR	36 1/4"	24"
V48 AR	48 1/4"	36"
V60 AR	60 1/4"	48"
V72 AR	72 1/4"	60"

V36 AR  
V48 AR  
V60 AR  
V72 AR

- Field trimmable
- Solid wood finished to match cabinet box exterior
- Dimension from height of arch to top of valance is 2 1/2"



### Crown Valance

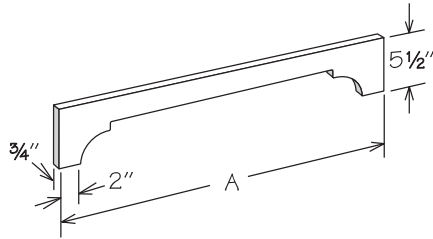

	A	Maximum Trim (1 1/2" each end)
V30 CR	30 1/4"	27 1/4"
V36 CR	36 1/4"	33 1/4"
V42 CR	42 1/4"	39 1/4"
V48 CR	48 1/4"	45 1/4"
V60 CR	60 1/4"	57 1/4"
V72 CR	72 1/4"	69 1/4"

V30 CR      V48 CR  
V36 CR      V60 CR  
V42 CR      V72 CR

- Field trimmable
- Solid wood finished to match cabinet box exterior
- Dimension from height of arch to top of valance is 2 1/4"

### Straight Valance

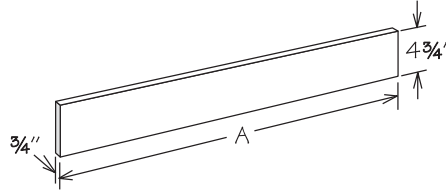

	A
V48 S	48 1/4"
V72 S	72 1/4"

V48 S  
V72 S

- Field trimmable
- Solid wood finished to match cabinet box exterior

### Traditional Valance

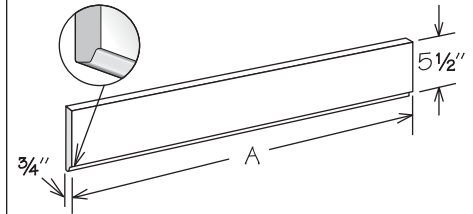

	A
V36 T	36 1/4"
V72 T	72 1/4"
V96 T	96 1/4"

V36 T  
V72 T  
V96 T

- Field trimmable
- Solid wood finished to match cabinet box exterior

Corbels

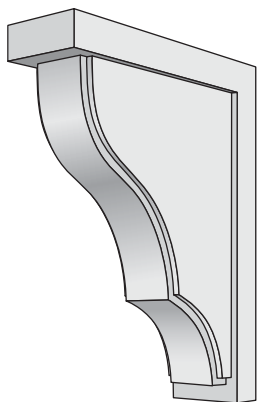

For additional decorative accessory designs, visit Designer Resources (<http://resources.shenandoahcabinetry.com/>).

Small Cove Corbel

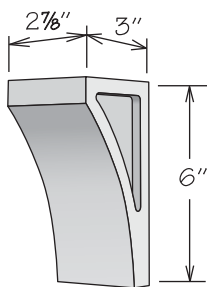

CC36

- Solid wood finished to match cabinet box exterior
- Recessed key hole brackets included
- For decorative use only
- Designed to complement the Parker legs and foot

Medium Cove Corbel

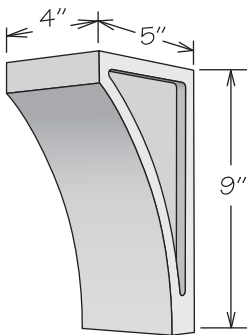

CC49

- Solid wood finished to match cabinet box exterior
- Recessed key hole brackets included
- For decorative use only
- Designed to complement the Parker legs and foot

Small Narrow Cove Corbel

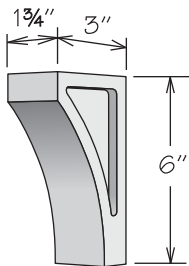

CC26

- Solid wood finished to match cabinet box exterior
- Recessed key hole brackets included
- For decorative use only
- Designed to complement the Parker legs and foot

Medium Narrow Cove Corbel

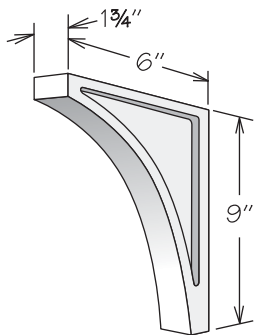

CC29

- Solid wood finished to match cabinet box exterior
- Recessed key hole brackets included
- For decorative use only
- Designed to complement the Parker legs and foot

Large Narrow Cove Corbel

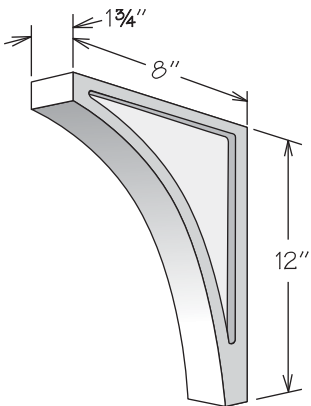

CC212

- Solid wood finished to match cabinet box exterior
- Recessed key hole brackets included
- For decorative use only
- Designed to complement the Parker legs and foot

### Small Valencia Corbel

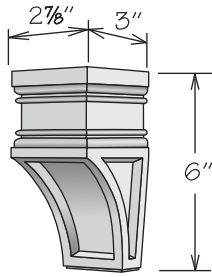

VC36

- Solid wood finished to match cabinet box exterior
- Recessed key hole brackets included
- For decorative use only
- Designed to complement the Estelle legs and foot

### Medium Valencia Corbel

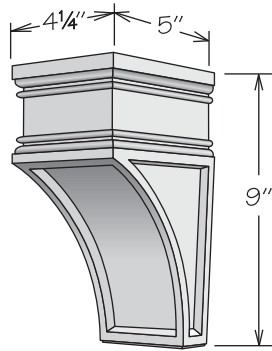

VC49

- Solid wood finished to match cabinet box exterior
- Recessed key hole brackets included
- For decorative use only
- Designed to complement the Estelle legs and foot

### Large Valencia Corbel

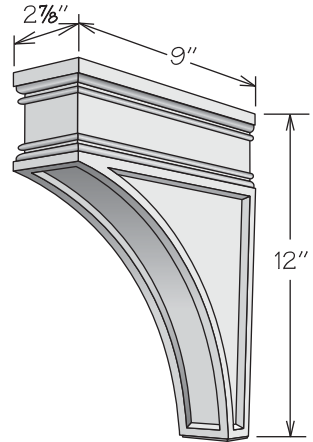

VC312

- Solid wood finished to match cabinet box exterior
- Recessed key hole brackets included
- For decorative use only
- Designed to complement the Estelle legs and foot

### Small Belhaven Corbel

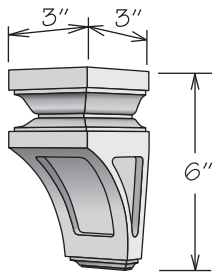

BC36

- Solid wood finished to match cabinet box exterior
- Recessed key hole brackets included
- For decorative use only
- Designed to complement the Yates legs and foot

### Medium Belhaven Corbel

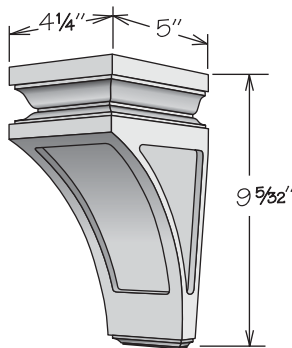

BC49

- Solid wood finished to match cabinet box exterior
- Recessed key hole brackets included
- For decorative use only
- Designed to complement the Yates legs and foot

### Large Belhaven Corbel

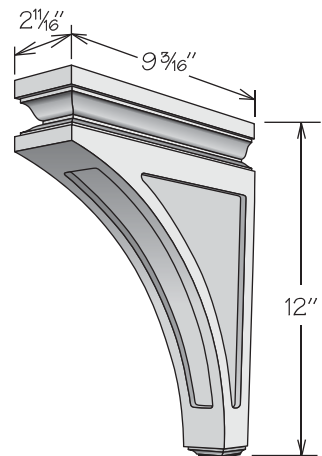

BC312

- Solid wood finished to match cabinet box exterior
- Recessed key hole brackets included
- For decorative use only
- Designed to complement the Yates legs and foot

Small Finley Corbel

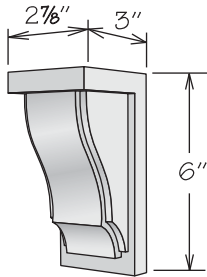

FC36

- Solid wood finished to match cabinet box exterior
- Recessed key hole brackets included
- For decorative use only
- Designed to complement the Orlean legs and foot

Medium Finley Corbel

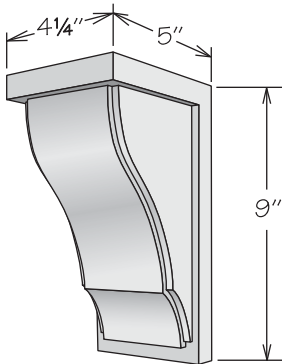

FC49

- Solid wood finished to match cabinet box exterior
- Recessed key hole brackets included
- For decorative use only
- Designed to complement the Orlean legs and foot

Large Finley Corbel

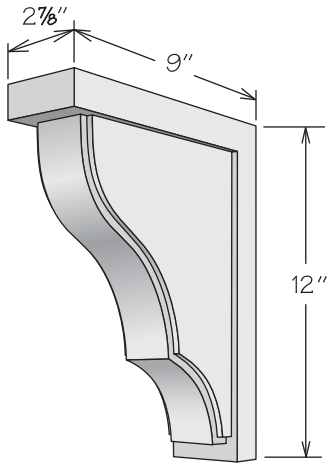

FC312

- Solid wood finished to match cabinet box exterior
- Recessed key hole brackets included
- For decorative use only
- Designed to complement the Orlean legs and foot

Small Prairie Corbel

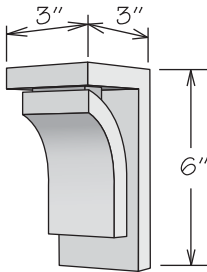

PC36

- Solid wood finished to match cabinet box exterior
- Recessed key hole brackets included
- For decorative use only
- Designed to complement the Parker legs and foot

Medium Prairie Corbel

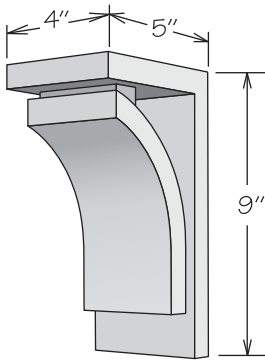

PC49

- Solid wood finished to match cabinet box exterior
- Recessed key hole brackets included
- For decorative use only
- Designed to complement the Parker legs and foot

Large Prairie Corbel

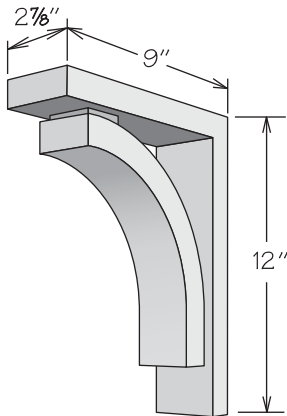

PC312

- Solid wood finished to match cabinet box exterior
- Recessed key hole brackets included
- For decorative use only
- Designed to complement the Parker legs and foot

**Small Rosette Corbel**

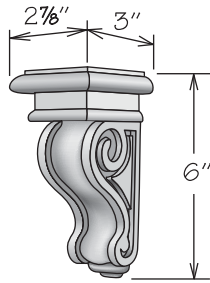

RC36

- Solid wood finished to match cabinet box exterior
- Recessed key hole brackets included
- For decorative use only
- Designed to complement the Chantilly legs and foot

**Medium Rosette Corbel**

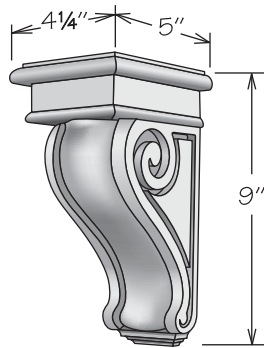

RC49

- Solid wood finished to match cabinet box exterior
- Recessed key hole brackets included
- For decorative use only
- Designed to complement the Chantilly legs and foot

**Large Rosette Corbel**

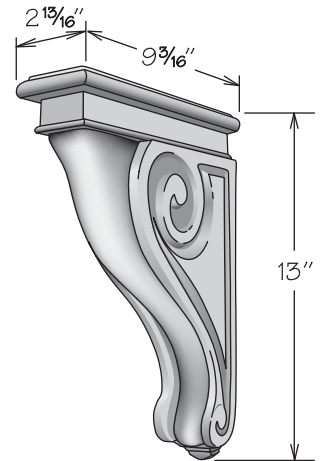

RC313

- Solid wood finished to match cabinet box exterior
- Recessed key hole brackets included
- For decorative use only
- Designed to complement the Chantilly legs and foot

**Small Laurel Corbel**

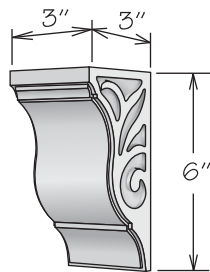

LC36

- Solid wood finished to match cabinet box exterior
- Recessed key hole brackets included
- For decorative use only
- Designed to complement the Chantilly legs and foot

**Medium Laurel Corbel**

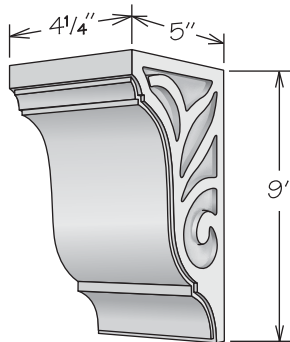

LC49

- Solid wood finished to match cabinet box exterior
- Recessed key hole brackets included
- For decorative use only
- Designed to complement the Chantilly legs and foot

**Large Laurel Corbel**

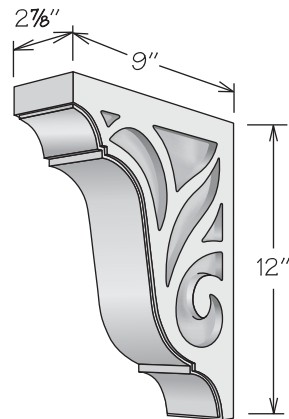

LC312

- Solid wood finished to match cabinet box exterior
- Recessed key hole brackets included
- For decorative use only
- Designed to complement the Chantilly legs and foot

### Metal Corbels

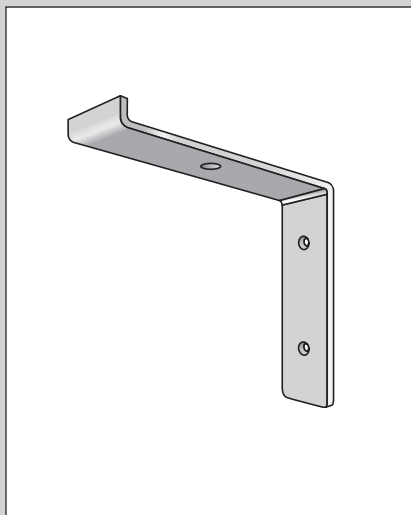

For additional decorative accessory designs, visit Designer Resources (<http://resources.shenandoahcabinetry.com/>).

### Metal Cove Corbel

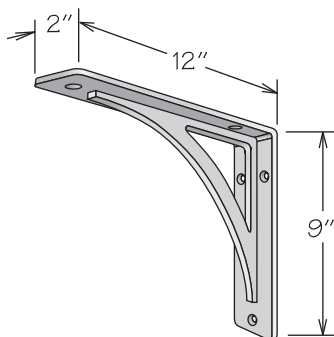

METAL COVE 212 VB  
METAL COVE 212 MB  
METAL COVE 212 SN  
METAL COVE 212 PC

- Weight capacity is 100lbs when installed per included installation instructions
- Installation hardware included
- Available in four metal finishes
  - VB - Verona Bronze
  - MB - Matte Black
  - SN - Satin Nickel
  - PC - Polished Chrome
- Can be installed using either height orientation

### Metal Emerson Corbel

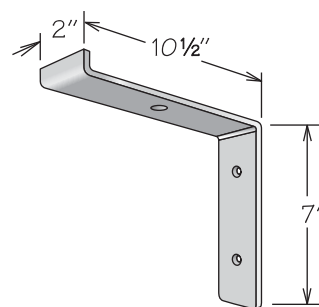

METAL EMERSON 27 VB  
METAL EMERSON 27 MB  
METAL EMERSON 27 SN  
METAL EMERSON 27 PC

- Weight capacity is 100lbs when installed per included installation instructions
- Installation hardware included
- Available in four metal finishes
  - VB - Verona Bronze
  - MB - Matte Black
  - SN - Satin Nickel
  - PC - Polished Chrome
- Can be used with floating shelf

### Countertop Support

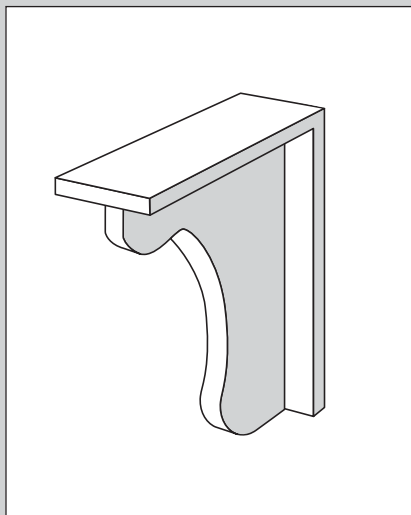

### Angled Countertop Support

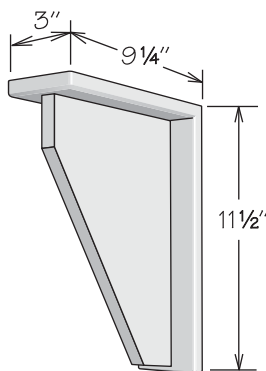

AS12

- Field installation accessory
- Decorative use only
- Features 5/8" solid wood finished to match cabinet box exterior

### Curved Countertop Support

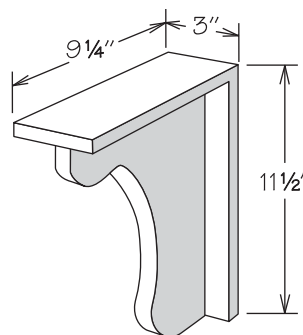

CS12

- Field installation accessory
- Decorative use only
- Features 5/8" solid wood finished to match cabinet box exterior

Legs, Feet & Posts

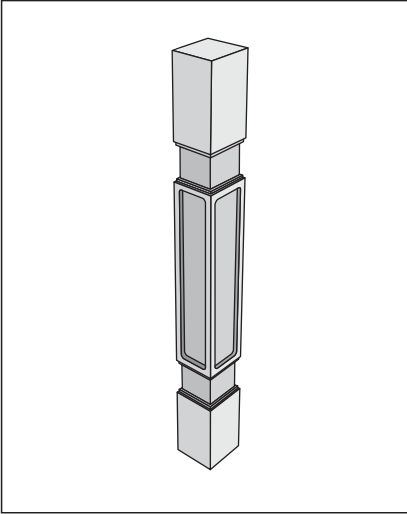

Base Tapered Leg

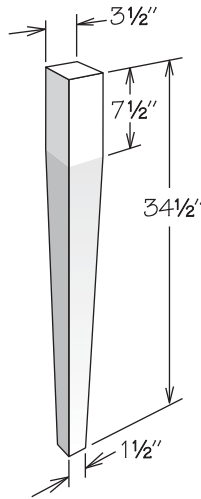

BTPL

- Features solid wood finished to match cabinet box exterior
- Tapered on all sides
- Field trimmable

Tapered Foot

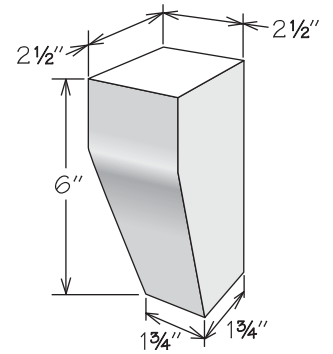

TPF

- Features solid wood finished to match cabinet box exterior
- Tapered on two sides
- Field trimmable to 4" high

Base Square Leg

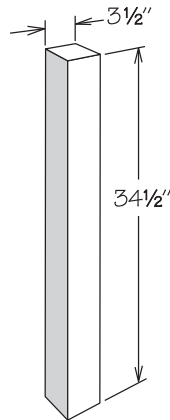

BSQL

- Features solid wood finished to match cabinet box exterior
- Field trimmable

Base Square Foot

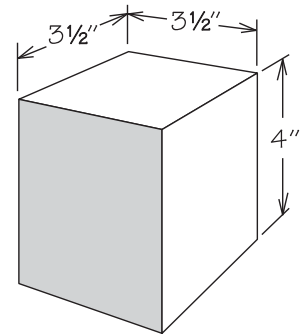

BSQF

- Features solid wood finished to match cabinet box exterior
- Designed as toe kick accent

Base Turned Leg

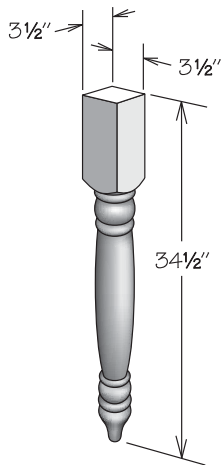

BTL

- Features solid wood finished to match cabinet box exterior
- Field trimmable to 28 1/2" high

Accent Turned Foot  
Full Round

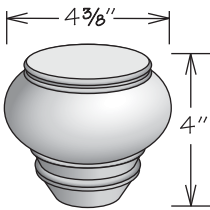

ATF-FR

- Features solid wood finished to match cabinet box exterior
- Designed as toe kick accent

Accent Turned Foot

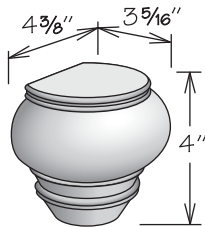

ATF

- Features solid wood finished to match cabinet box exterior
- Designed as toe kick accent

Full-Turned Post Fluted

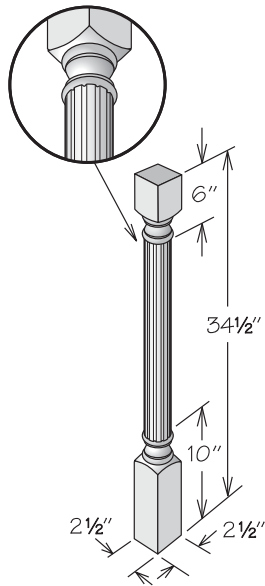

POST234 F

- Fluted round post
- Features solid wood finished to match cabinet box exterior
- Field trimmable to 28 1/2" high

Full-Turned Post Beaded

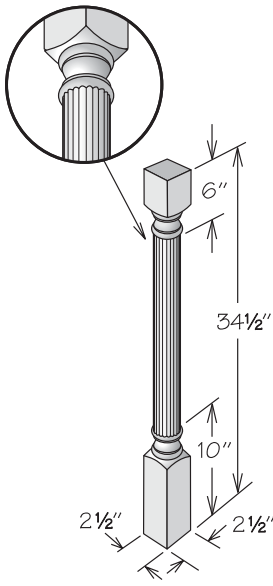

POST234 B

- Beaded round post
- Features solid wood finished to match cabinet box exterior
- Field trimmable to 28 1/2" high



### Parker Decorative Leg

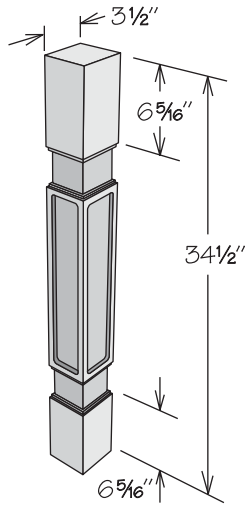

PDL

- Features solid wood finished to match cabinet box exterior
- Field trimmable
- Designed to complement the Prairie or Cove corbels

### Parker Furniture Leg

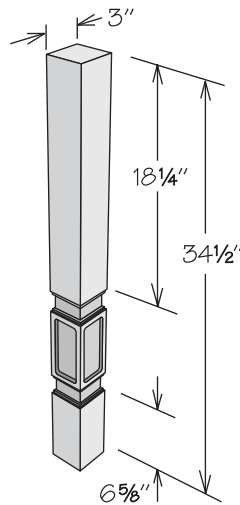

PFL

- Features solid wood finished to match cabinet box exterior
- Field trimmable
- Designed to complement the Prairie or Cove corbels

### Parker Decorative Foot

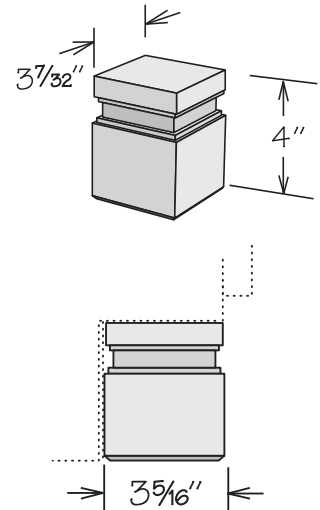

PDF

- Features solid wood finished to match cabinet box exterior
- Designed as toe kick accent
- Designed to complement the Prairie or Cove corbels

### Estelle Decorative Leg

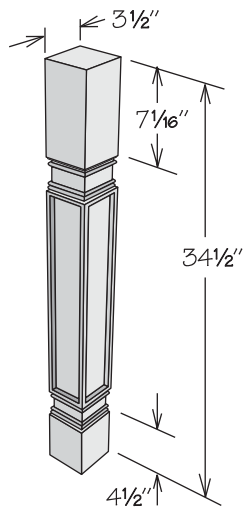

EDL

- Features solid wood finished to match cabinet box exterior
- Field trimmable
- Designed to complement the Valencia corbels

### Estelle Furniture Leg

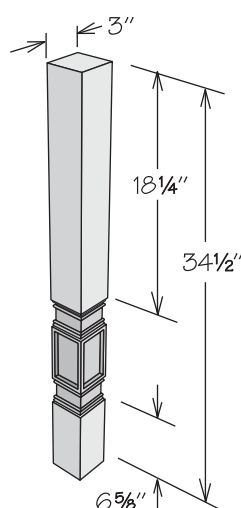

EFL

- Features solid wood finished to match cabinet box exterior
- Field trimmable
- Designed to complement the Valencia corbels

### Estelle Decorative Foot

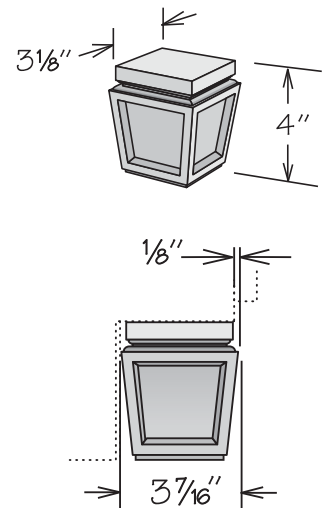

EDF

- Features solid wood finished to match cabinet box exterior
- Designed as toe kick accent
- Designed to complement the Valencia corbels

Yates Decorative Leg

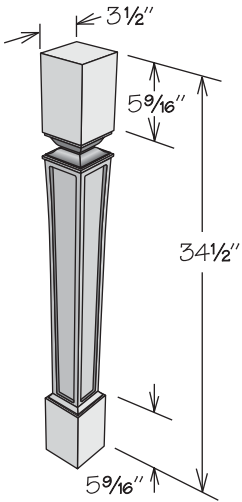

YDL

- Features solid wood finished to match cabinet box exterior
- Field trimmable
- Designed to complement the Belhaven corbels

Yates Furniture Leg

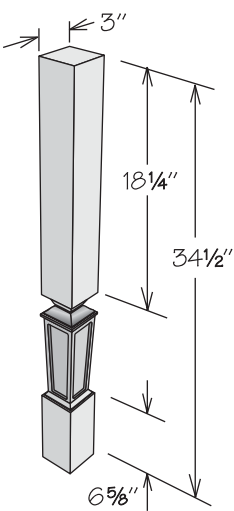

YFL

- Features solid wood finished to match cabinet box exterior
- Field trimmable
- Designed to complement the Belhaven corbels

Yates Decorative Foot

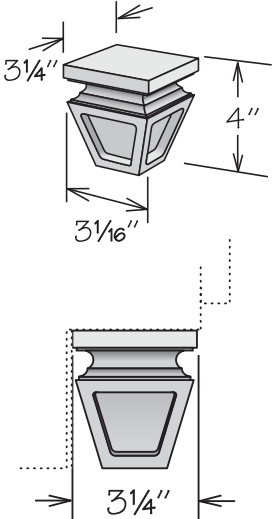

YDF

- Features solid wood finished to match cabinet box exterior
- Designed as toe kick accent
- Designed to complement the Belhaven corbels

Orlean Decorative Leg

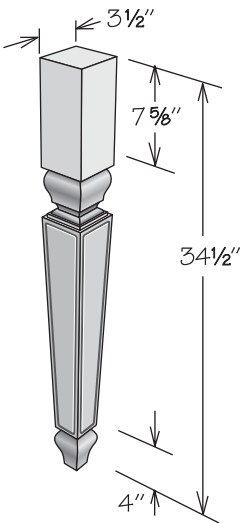

ODL

- Features solid wood finished to match cabinet box exterior
- Field trimmable
- Designed to complement the Finley corbels

Orlean Furniture Leg

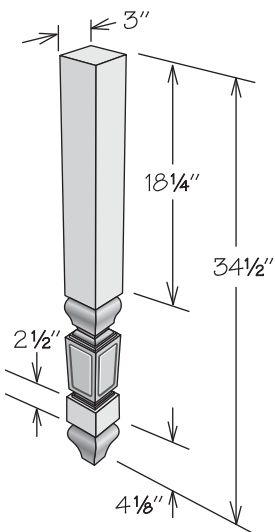

OFL

- Features solid wood finished to match cabinet box exterior
- Field trimmable
- Designed to complement the Finley corbels

Orlean Decorative Foot

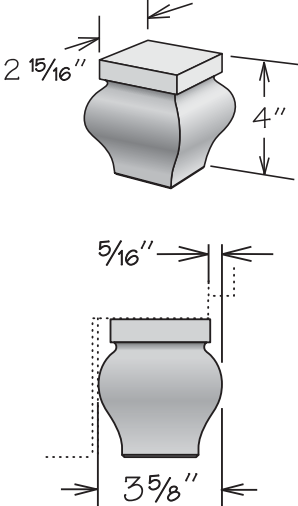

ODF

- Features solid wood finished to match cabinet box exterior
- Designed as toe kick accent
- Designed to complement the Finley corbels

### Chantilly Decorative Leg

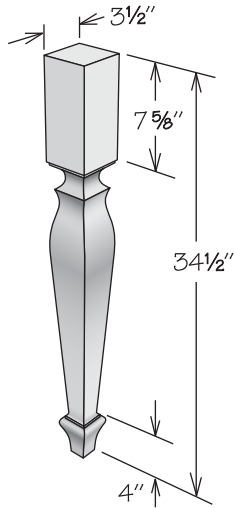

CDL

- Features solid wood finished to match cabinet box exterior
- Field trimmable
- Designed to complement the Laurel or Rosette corbels

### Chantilly Furniture Leg

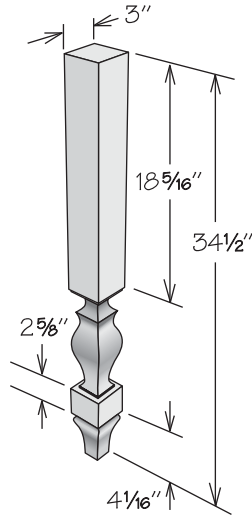

CFL

- Features solid wood finished to match cabinet box exterior
- Field trimmable
- Designed to complement the Laurel or Rosette corbels

### Chantilly Decorative Foot

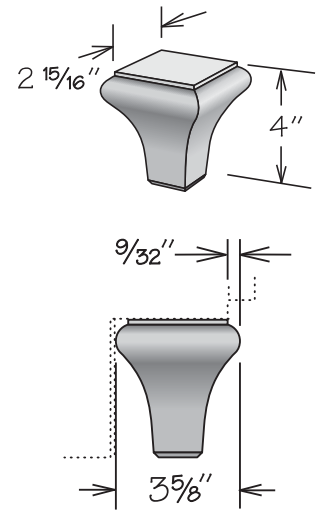

CDF

- Features solid wood finished to match cabinet box exterior
- Designed as toe kick accent
- Designed to complement the Laurel or Rosette corbels

PANELS, FILLERS & DECORATIVE ITEMS: Furniture Toe Kick

Decorative Furniture  
Toe Kick Corner

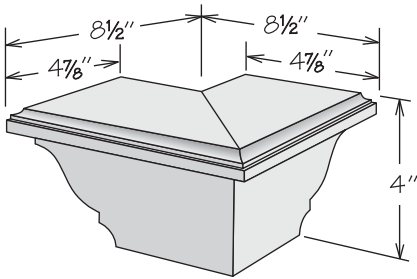

DFTK-C

- Features solid wood finished to match cabinet box exterior
- Only for use on cabinet with Recessed Toe Kick Option (RTK)
- Decorator Matching Door and Furniture End Option (FE) or BEP panel recommended
- Field trimmable in depth
- Reversible for left or right installation

Decorative Furniture  
Toe Kick End

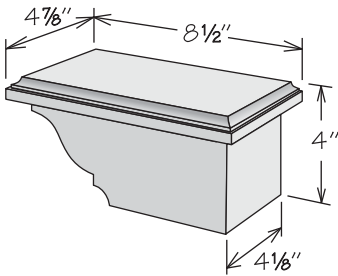

DFTK-E L  
DFTK-E R

- Features solid wood finished to match cabinet box exterior
- Recommended for end-of-run application when space allows for an overhang (i.e. end-of-run not against a wall, stand alone vanity, etc.)
- Decorator Matching Door and Furniture End Option (FE) or BEP panel recommended
- Field trimmable in depth
- Right shown

Decorative Furniture  
Toe Kick

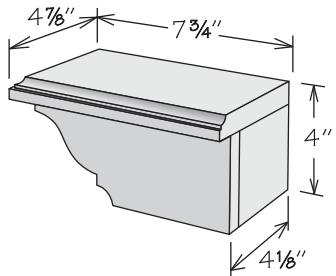

DFTK L  
DFTK R

- Features solid wood finished to match cabinet box exterior
- Recommended for applications that do not allow for an overhang (i.e. against a wall, panel or when using a left and right together)
- Features flush end
- Field trimmable in depth
- Right shown

Classic Furniture  
Toe Kick Corner

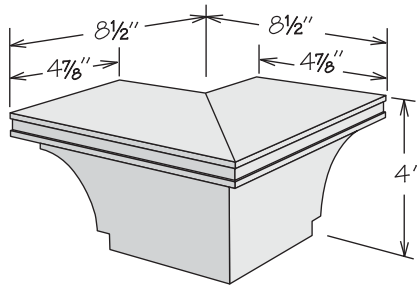

CFTK-C

- Features solid wood finished to match cabinet box exterior
- Only for use on cabinet with Recessed Toe Kick Option (RTK)
- Decorator Matching Door and Furniture End Option (FE) or BEP panel recommended
- Field trimmable in depth
- Reversible for left or right installation

Classic Furniture  
Toe Kick End

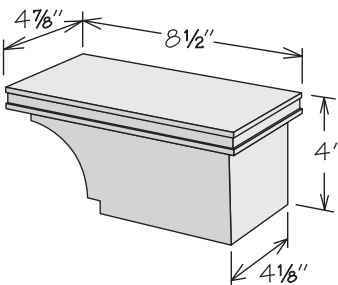

CFTK-E L  
CFTK-E R

- Features solid wood finished to match cabinet box exterior
- Recommended for end-of-run application when space allows for an overhang (i.e. end-of-run not against a wall, stand alone vanity, etc.)
- Decorator Matching Door and Furniture End Option (FE) or BEP panel recommended
- Field trimmable in depth
- Right shown

Classic Furniture  
Toe Kick

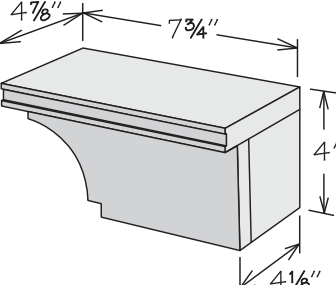

CFTK L  
CFTK R

- Features solid wood finished to match cabinet box exterior
- Recommended for applications that do not allow for an overhang (i.e. against a wall, panel or when using a left and right together)
- Features flush end
- Field trimmable in depth
- Right shown

### Decorative Furniture Toe Kick - Recessed Toe Kick Application

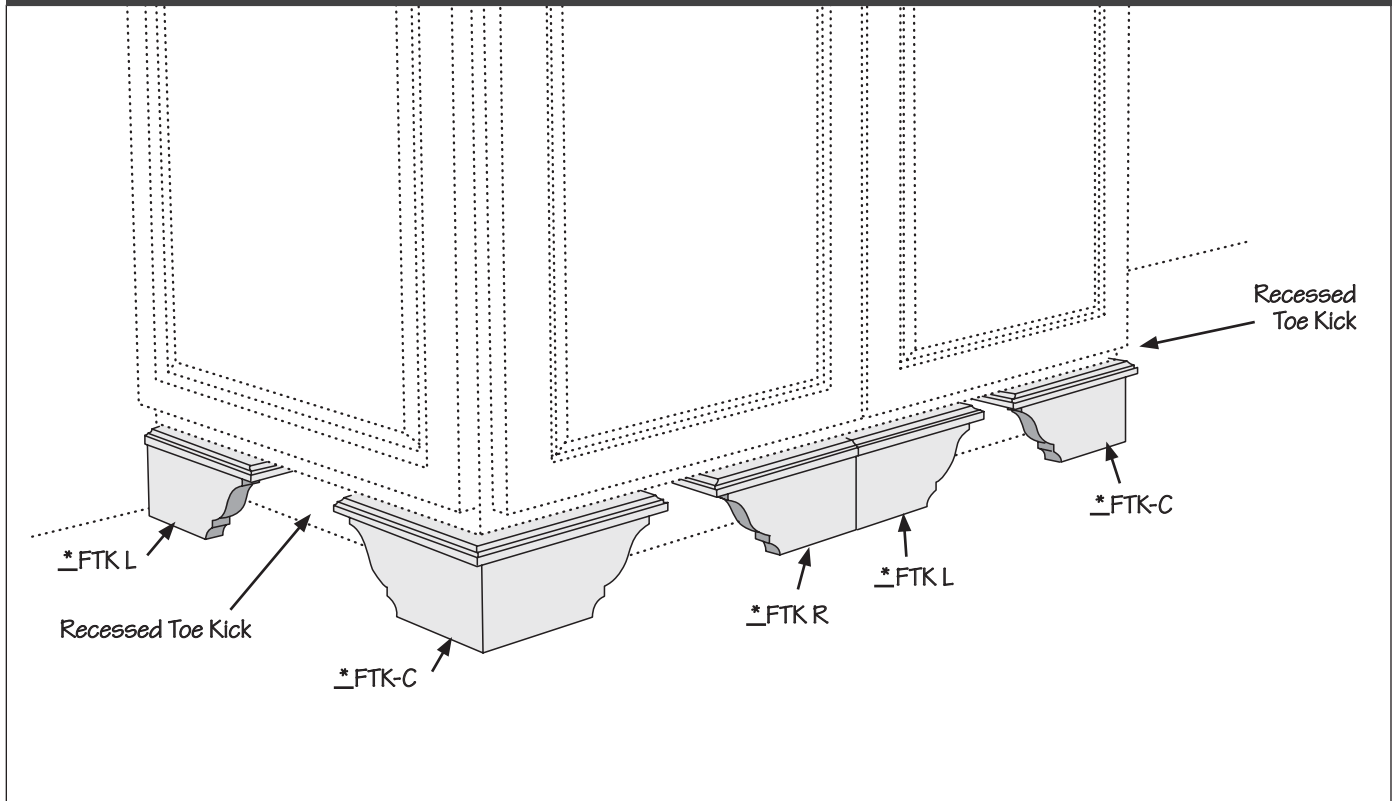

### Decorative Furniture Toe Kick - Standard Toe Kick Application

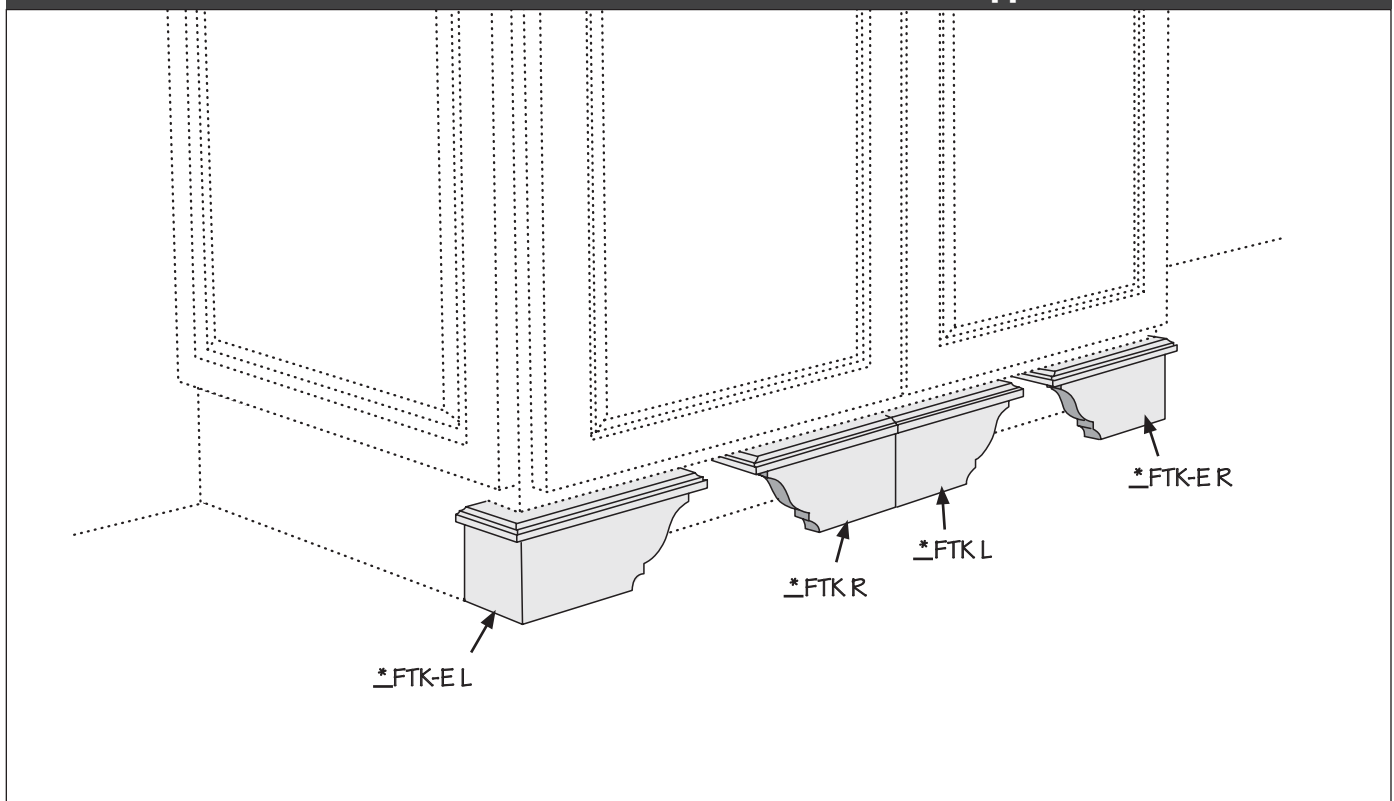

Replace \*\_ with "D" for Decorative or "C" for Classic

Split Post

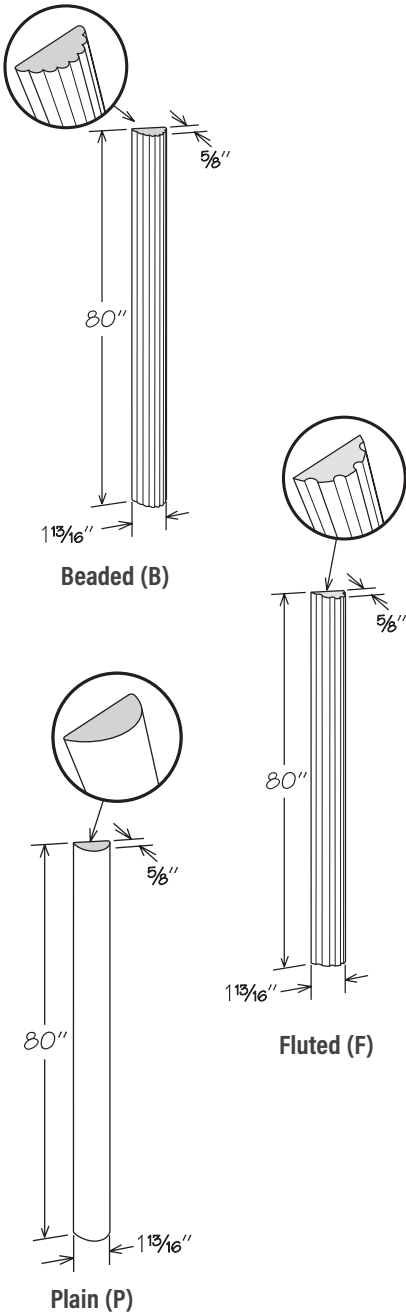

SPLT POST80 B  
SPLT POST80 F  
SPLT POST80 P

- Features solid wood finished to match cabinet box exterior
- Field trimmable
- Use with Traditional Split Blocks and Collar to create design element
- Must be mounted to a Universal Filler – order separately

Traditional Split Block – 6"

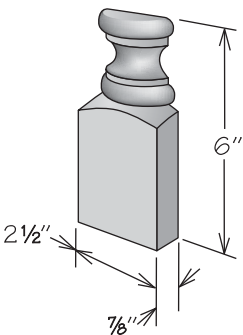

SPLT BLOCK26 T

- Features solid wood finished to match cabinet box exterior
- For floor or wall application
- Must be mounted to a Universal Filler – order separately

Traditional Split Block – 10"

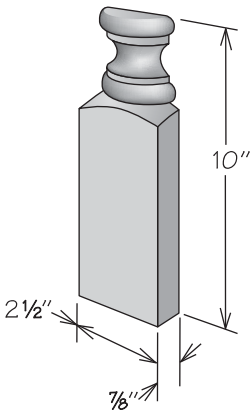

SPLT BLOCK210 T

- Features solid wood finished to match cabinet box exterior
- For floor application
- Must be mounted to a Universal Filler – order separately

Traditional Split Collar

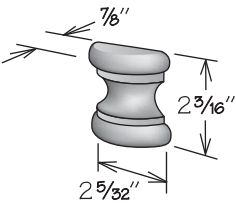

SPLT COLLAR T

- Features solid wood finished to match cabinet box exterior
- Must be mounted to a Universal Filler – order separately

Suggested Design Applications

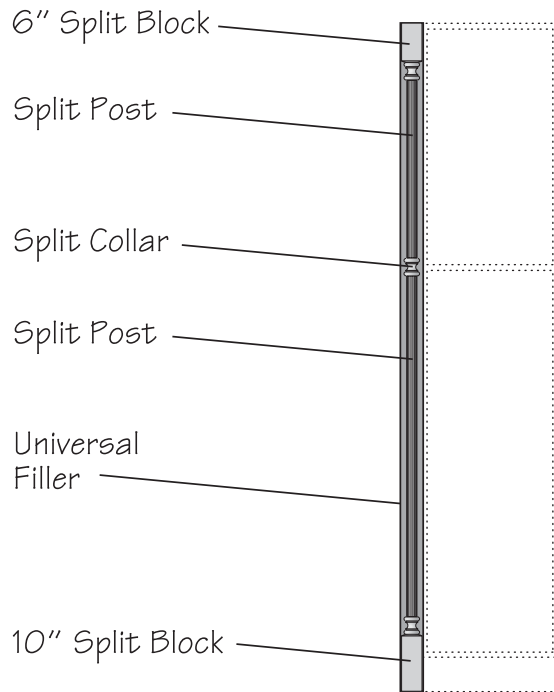

Tall Cabinet

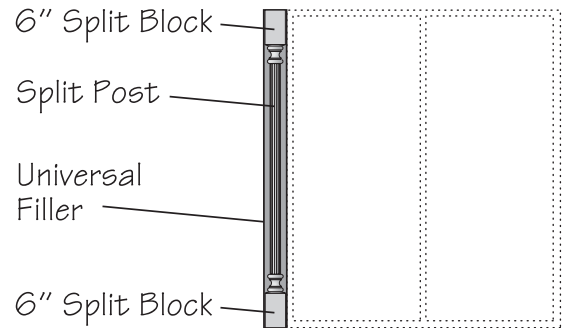

Wall Cabinet

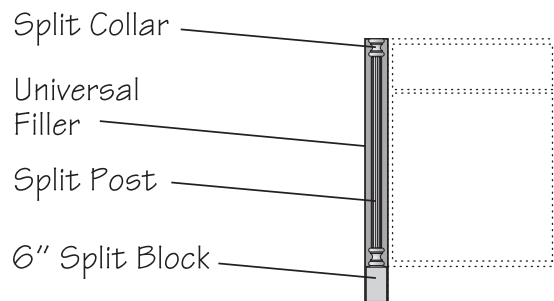

Base Cabinet

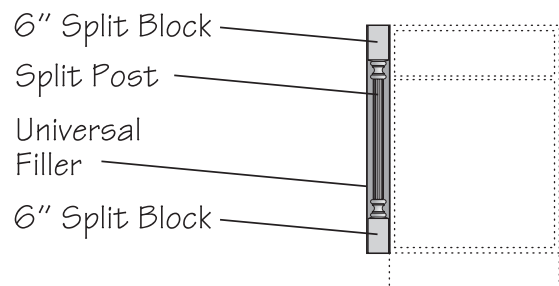

Base Cabinet

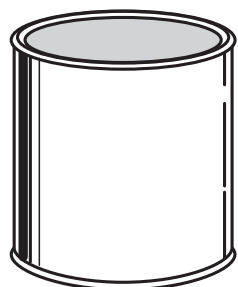
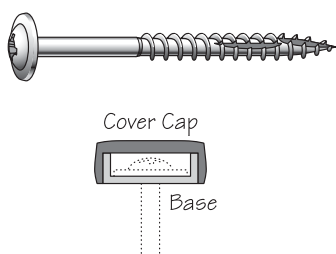
**Installation Items**

**Screws & Screw Cover Caps**

SCREW INST 2.5 BX100  
(Box of 100)

COVER CAP TAN  
COVER CAP WHT  
(Bag of 50)

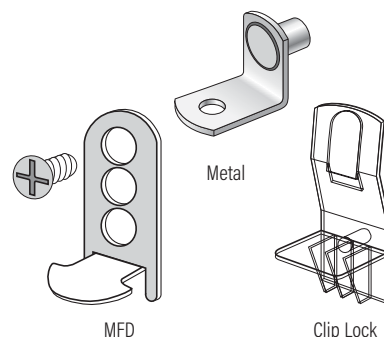
- Installation screws are Phillips pan head with attached washer 2½" long
- Cover caps used to conceal head of installation screw

**Shelf Rests**

SHELF REST METAL 4PK  
(Package of 4 – Wall cabinets or Bookshelves)

SHELF REST METAL 12  
(Package of 12 – Wall cabinets or Bookshelves)

SHELF REST MFD PK  
(Package of 8 – MFD cabinets)

CLIP LOCK 3/4 4 PK  
(Package of 4 – Base or Tall cabinets)

- Metal and MFD shelf rests are nickel-plated steel
- MFD shelf rests are six-position adjustable for alignment of shelf with mullion
- Clip Lock shelf rests are molded clear high-strength polycarbonate

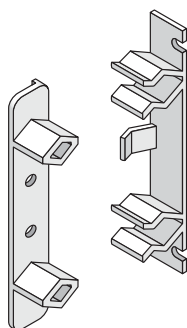
**Dummy Drawer Front Fastener**

DDF FASTENER

- For installation of one dummy drawer front
- Kit features:
  - Two sets of DDF Fasteners
  - Eight screws
  - One Instruction Sheet
- Please refer to cabinet specifications as some cabinets will require more than one kit

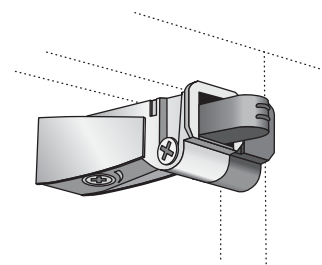
**CushionClose Door Buffer**

CUSH CLOSE DR BUFFER

- Field installation accessory
- Slow closing system helps reduce slams and noise
- Package includes one unit and installation instructions
- Pre-drilling of face frames recommended
- One unit per door recommended for doors up to 30" high
- Two units per door recommended for doors 36" and higher
- Not for use on the following SKUs: BEA12 FH, BER, BFP3, BPP9, BPP12, BPPUS9, BPPUS12, BSS, BTDP9, BWBB, CAR, DFDC, DWBB, VWBB, WEA, WER or WTH



### Cleat

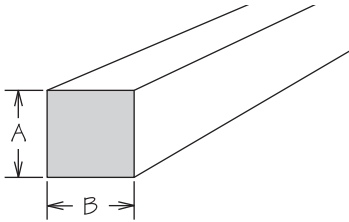

	A	B
HWC 1/2X1/2X96	1/2"	1/2"
HWC 3/4X3/4X96	3/4"	3/4"
HWC 1X2X96	3/4"	1 1/2"
HWC 2X4X96	1 1/2"	3 1/2"

HWC 1/2X1/2X96  
HWC 3/4X3/4X96  
HWC 1X2X96  
HWC 2X4X96

- Unfinished
- HWC 1/2X1/2X96 and HWC 3/4X3/4X96 are shipped in two 48" long pieces

### Stain

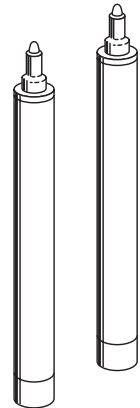
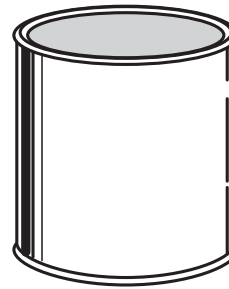

STAIN PINT  
STAIN QUART  
STAIN GLAZED PINT  
STAIN GLAZED QUART  
STAIN GLAZED PENS  
STAIN TOP COAT PINT  
STAIN TOP COAT QUART

- STAIN PINT (QUART) for use on all non-glazed stains and non-glazed painted finishes
- STAIN GLAZED PINT (QUART) for use on all glazed stains and glazed painted finishes
- STAIN TOP COAT strongly recommended for application over ALL finishes – order separately
- STAIN GLAZED includes STAIN PINT and two STAIN GLAZED PENS per pint
- STAIN GLAZED PENS available for order separately (quantity of two)
- Indicate species and finish when ordering
- PINT covers approximately 40 square feet
- QUART covers approximately 80 square feet
- Instructions included

### Spray Stain

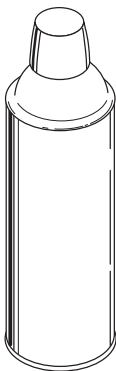

SPRAY STAIN CLEAR  
SPRAY STAIN TINTED

- SPRAY STAIN TINTED available for wood and painted finishes excluding Maple Auburn, Maple Cognac, Maple Espresso, **Maple Slate** and all Cherry finishes
- SPRAY STAIN CLEAR for use as top coat for all finishes
- Indicate species and finish when ordering
- 11-ounce aerosol spray can

### Hinge Restrictor Clip

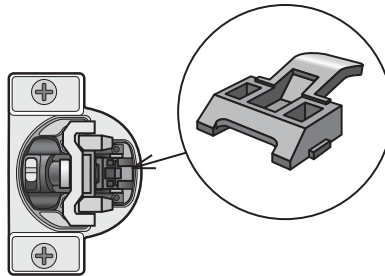

HINGE CC ANG RES CLP

- Limits door opening to 86 degrees to avoid contact with adjacent objects
- For use on CushionClose hinges only
- Package includes 10 per bag (1 required per hinge)

### Edge Banding Duraform Textured

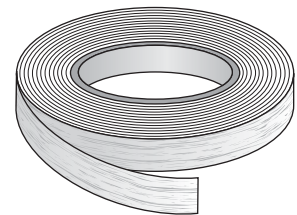

	Height	Length
EDGE BAND 25 DT	7/8"	25 feet
EDGE BAND TAPE 50	1"	50 feet

EDGE BAND 25 DT  
EDGE BAND TAPE 50

- Available for Breeze, Cascade and Drift finishes only
- Field trimmable
- Tape must be ordered with edge banding for installation

Putty Stick & Marker

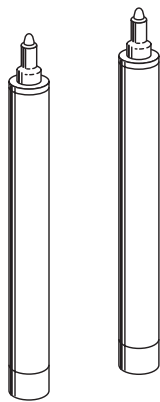

PUTTY STICK EXT QTY1  
PUTTY STICK EXT QTY2  
PUTTY STICK INTERIOR

TU MARKER DURAFORM  
TU MARKER EXT QTY1  
TU MARKER EXT QTY2  
TU MARKER INTERIOR

- Indicate species and finish when ordering
- Refer to chart to order correct QTY
- Putty Stick – for filling minor dents, gouges and scratches made during or after installation
- Touch Up Marker – adds color to minor surface scratches
- Touch up for Duraform Breeze, Cascade and Drift will match the cabinet box exterior

Finish	Putty Stick	TU Marker
Cherry Autumn	PUTTY STICK EXT QTY1	TU MARKER EXT QTY2
Cherry Bordeaux	PUTTY STICK EXT QTY1	TU MARKER EXT QTY2
Cherry Java	PUTTY STICK EXT QTY1	TU MARKER EXT QTY1
Cherry Slate	PUTTY STICK EXT QTY1	TU MARKER EXT QTY1
Cherry Spice	PUTTY STICK EXT QTY2	TU MARKER EXT QTY1
Duraform Breeze	PUTTY STICK EXT QTY1	TU MARKER EXT QTY2
Duraform Cascade	PUTTY STICK EXT QTY1	TU MARKER EXT QTY2
Duraform Drift	PUTTY STICK EXT QTY1	TU MARKER EXT QTY1
Duraform Linen	PUTTY STICK EXT QTY2	TU MARKER DURAFORM
Duraform Silk	PUTTY STICK EXT QTY1	TU MARKER DURAFORM
Duraform Stone	PUTTY STICK EXT QTY1	TU MARKER DURAFORM
Maple Auburn	PUTTY STICK EXT QTY1	TU MARKER EXT QTY2
Maple Cognac	PUTTY STICK EXT QTY1	TU MARKER EXT QTY1
Maple Espresso	PUTTY STICK EXT QTY1	TU MARKER EXT QTY2
Maple Mocha	PUTTY STICK EXT QTY1	TU MARKER EXT QTY2
Maple Rye	PUTTY STICK EXT QTY1	TU MARKER EXT QTY1
Maple Slate	PUTTY STICK EXT QTY1	TU MARKER EXT QTY1
Maple Spice	PUTTY STICK EXT QTY1	TU MARKER EXT QTY1
Maple Truffle	PUTTY STICK EXT QTY1	TU MARKER EXT QTY2
Painted Boulder	PUTTY STICK EXT QTY1	TU MARKER EXT QTY1
Painted Ember	PUTTY STICK EXT QTY1	TU MARKER EXT QTY2
Painted Harbor	PUTTY STICK EXT QTY1	TU MARKER EXT QTY1
Painted Hazelnut	PUTTY STICK EXT QTY1	TU MARKER EXT QTY2
Painted Linen	PUTTY STICK EXT QTY2	TU MARKER EXT QTY2
Painted Pewter	PUTTY STICK EXT QTY1	TU MARKER EXT QTY2
Painted Silk	PUTTY STICK EXT QTY1	TU MARKER EXT QTY1
Painted Stone	PUTTY STICK EXT QTY1	TU MARKER EXT QTY1
Interior	PUTTY STICK INTERIOR	TU MARKER INTERIOR