

Panels, Fillers & Decorative Items

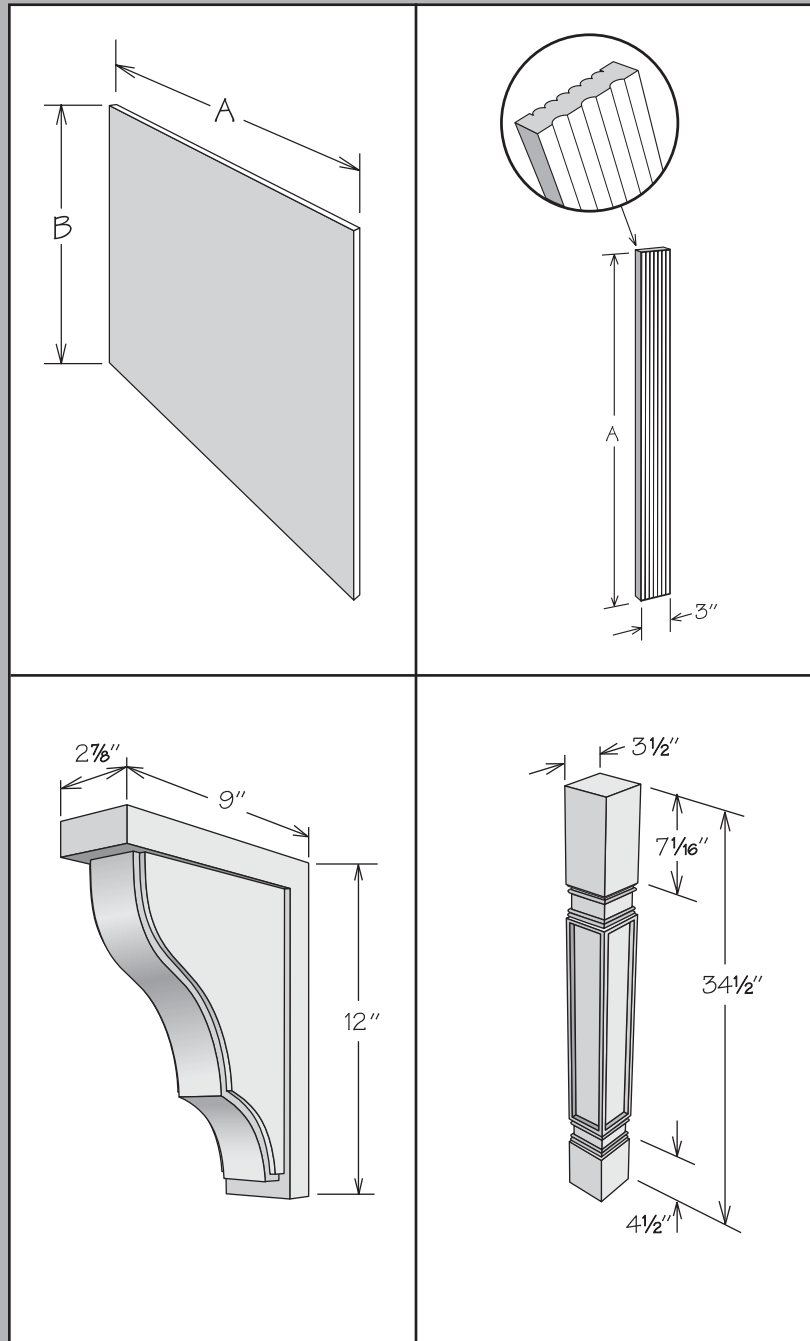

Panels

Desk End Panel

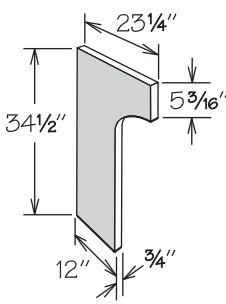

DEP

- Features 3/4" engineered wood with both sides finished to match cabinet exterior
- Recommend QM8 be ordered for installation to ensure proper attachment to wall
- Edge banded on front
- Field trimmable

Dishwasher Return

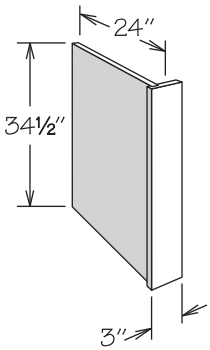

DWR3

APC
FE
PE

- Reversible for left or right installation
- Solid wood front
- Features 1/2" engineered wood with outside to match cabinet exterior and inside with a natural woodgrain look
- Attaching blocks included
- Field trimmable to 1" in width
- Can be notched for toe kick in the field

Sink / Vanity Front Return

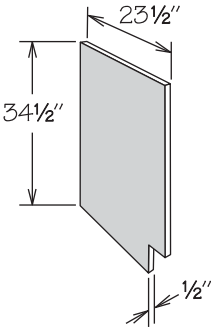

SFRR
SFRL

APC
FE
PE

- Features 1/2" engineered wood with outside to match cabinet exterior and inside with a natural woodgrain look
- SKU signifies left or right return
- Attaching blocks included
- When ordered with Furniture Ends Option (FE) return will feature a rabbeted front edge
- Field trimmable

Sink / Vanity Front Floor

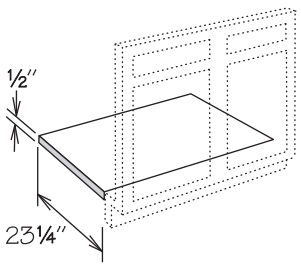

FL24	FL48X48
FL36	FL60
FL36X36	FL72
FL48	

- Features 1/2" engineered wood with one side finished with a natural woodgrain look
- 1/2" oversize in width
- FL36X36 to be used for CSF36 (trim to fit)
- FL48X48 to be used for CSF42 (trim to fit)
- Field trimmable

End Panel

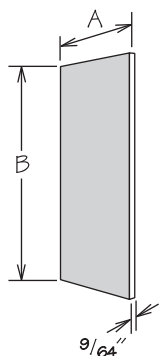

	A	B
WEP30	11¼"	30¾"
WEP42	11¼"	42⅝"
WEP48	11¼"	48"
WEP1542	14¼"	42⅝"
BEP34	23¼"	34½"
TEP84	23¼"	84"
TEP96	23¼"	96"
TEP120	23¼"	120"

WEP30
WEP42
WEP48
WEP1542
BEP34
TEP84
TEP96
TEP120

- Features plywood or engineered wood finished on one side to match cabinet box exterior
- Field trimmable, can be notched for toe kick

End Panel Duraform Textured

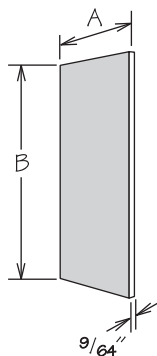

	A	B
WEP30 DT	11¼"	30¾"
WEP42 DT	11¼"	42⅝"
WEP48 DT	11¼"	48"
WEP1542 DT	14¼"	42⅝"
BEP34 DT	23¼"	34½"
TEP84 DT	23¼"	84"
TEP96 DT	23¼"	96"
TEP120 DT	23¼"	120"

WEP30 DT
WEP42 DT
WEP48 DT
WEP1542 DT
BEP34 DT
TEP84 DT
TEP96 DT
TEP120 DT

- Available for Breeze and Drift finishes only
- Features textured PVC-wrapped engineered wood finished on one side to match cabinet door
- Field trimmable, can be notched for toe kick

Grooved End Panel

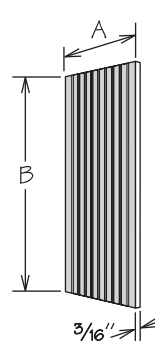

	A	B
WEP30 GROOVED	11¼"	30¾"
WEP42 GROOVED	11¼"	42⅝"
WEP48 GROOVED	11¼"	48"
WEP1542 GROOVED	14¼"	42⅝"
BEP34 GROOVED	23¼"	34½"
TEP84 GROOVED	23¼"	84"
TEP96 GROOVED	23¼"	96"

WEP30 GROOVED
WEP42 GROOVED
WEP48 GROOVED
WEP1542 GROOVED
BEP34 GROOVED
TEP84 GROOVED
TEP96 GROOVED

- Grooved every 1½" on one side
- Features ⅝" plywood finished to match cabinet box exterior on one side
- Grooves are beaded to complement the Cottage door style
- Field trimmable, can be notched for toe kick

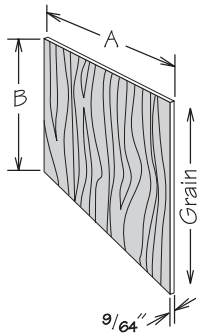
Finished Paneling

	A	B
FP4834	48"	34½"
FP4896	48"	96"
FP9634	96"	34½"
FP9648	96"	48"

FP4834
FP4896
FP9634
FP9648

- Features plywood or engineered wood finished on one side to match cabinet box exterior
- Field trimmable, can be notched for toe kick

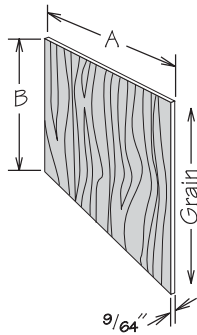
Finished Paneling**Duraform Textured**

	A	B
FP4834 DT	48"	34½"
FP4896 DT	48"	96"
FP9634 DT	96"	34½"

FP4834 DT
FP4896 DT
FP9634 DT

- Available for Breeze and Drift finishes only
- Features textured PVC-wrapped engineered wood finished on one side to match cabinet door
- FP9634 DT is shipped as two 48" wide x 34½" high panels
- Field trimmable, can be notched for toe kick

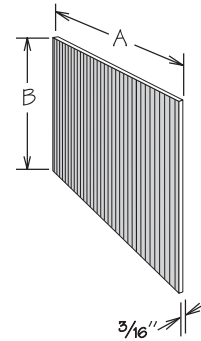
Grooved Finished Paneling

	A	B
FP4834 GROOVED	48"	34½"
FP4896 GROOVED	48"	96"
FP9634 GROOVED	96"	34½"

FP4834 GROOVED
FP4896 GROOVED
FP9634 GROOVED

- Grooved every 1½" on one side
- Features ¾" plywood finished to match cabinet box exterior on one side
- FP9634 GROOVED is shipped as two 48" wide x 34½" high panels
- Grooves are beaded to complement the Cottage door style
- Field trimmable, can be notched for toe kick

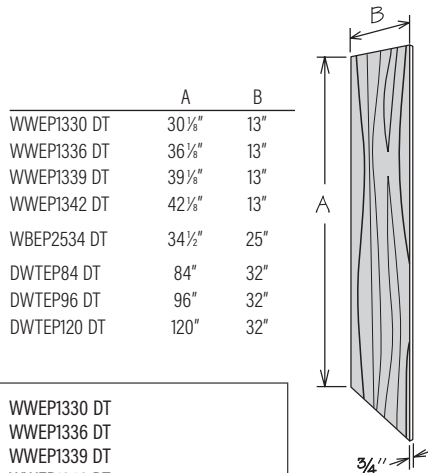
Wood End Panel**Duraform Textured**

	A	B
WWEP1330 DT	30⅞"	13"
WWEP1336 DT	36⅞"	13"
WWEP1339 DT	39⅞"	13"
WWEP1342 DT	42⅞"	13"
WBEP2534 DT	34½"	25"
DWTEP84 DT	84"	32"
DWTEP96 DT	96"	32"
DWTEP120 DT	120"	32"

WWEP1330 DT
WWEP1336 DT
WWEP1339 DT
WWEP1342 DT
WBEP2534 DT
DWTEP84 DT
DWTEP96 DT
DWTEP120 DT

- Available for Breeze and Drift finishes only
- Features textured PVC-wrapped engineered wood finished on both sides to match cabinet door
- WBEP_DT and DWTEP_DT are edge banded on both long sides
- WWEP_DT is edge banded on all four sides
- Field trimmable, can be notched for toe kick

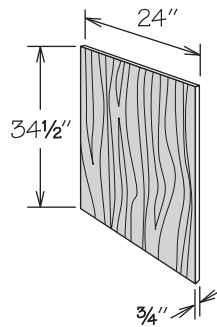
Wood Base End Panel

WBEP

- Engineered wood finished to match cabinet box exterior on both sides
- Edge banded on both long edges
- Field trimmable, can be notched for toe kick

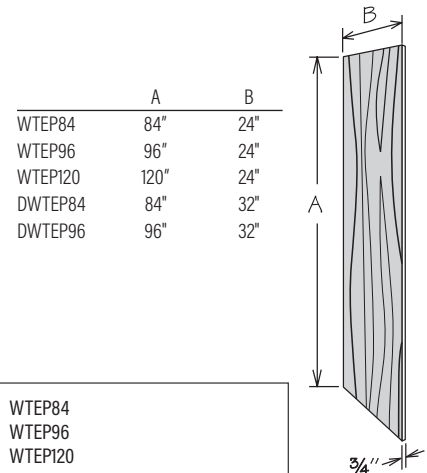
Wood Tall End Panel

	A	B
WTEP84	84"	24"
WTEP96	96"	24"
WTEP120	120"	24"
DWTEP84	84"	32"
DWTEP96	96"	32"

WTEP84
WTEP96
WTEP120
DWTEP84
DWTEP96

- Engineered wood finished to match cabinet box exterior on both sides
- Edge banded on both long edges
- Field trimmable, can be notched for toe kick

Refrigerator Return

24" Deep, 1/2" Panel

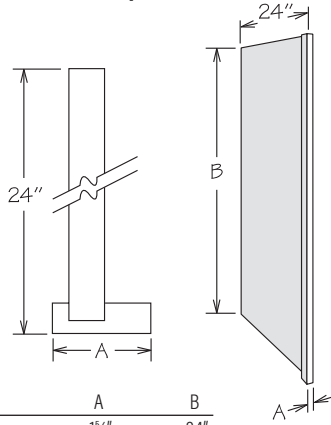

	A	B
RR84	1 5/8"	84"
RR384	3"	84"
RR96	1 5/8"	96"
RR396	3"	96"

RR84	RR384	APC
RR96	RR396	FE
		MI
		PE

- Reversible for left or right installation
- Solid wood front
- Features 1/2" engineered wood with outside finished to match cabinet exterior and inside with a natural woodgrain look
- Field trimmable, can be notched for toe kick

Refrigerator Return

32" Deep, 1/2" Panel

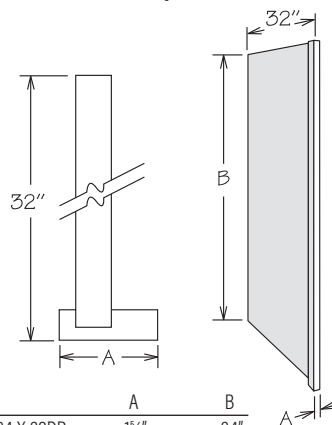

	A	B
RR84 X 32DP	1 5/8"	84"
RR384 X 32DP	3"	84"
RR96 X 32DP	1 5/8"	96"
RR396 X 32DP	3"	96"

RR84 X 32DP	RR384 X 32DP	FE
RR96 X 32DP	RR396 X 32DP	MI
		RD

- Reversible for left or right installation
- Solid wood front
- Features 1/2" plywood finished on outside to match cabinet exterior and natural woodgrain look on inside
- Field trimmable, can be notched for toe kick

Refrigerator Return

24" Deep, 3/4" Panel

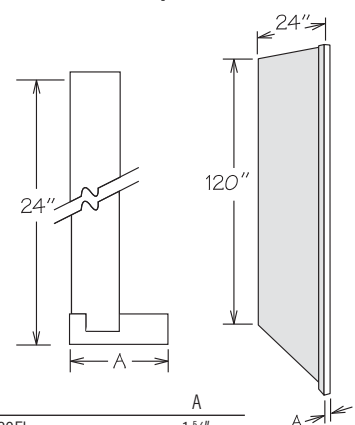

	A
RR120FL	1 5/8"
RR3120FL	3"

RR120FL	APC
RR3120FL	

- Reversible for left or right installation
- Solid wood front
- Features 3/4" engineered wood with both sides finished to match cabinet exterior
- Field trimmable, can be notched for toe kick

Refrigerator Return

32" Deep, 3/4" Panel

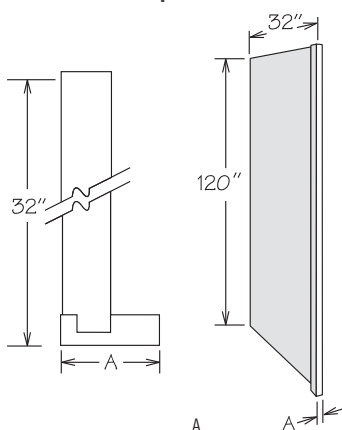

	A
RR120FL X 32DP	1 5/8"
RR3120FL X 32DP	3"

RR120FL X 32DP	RD
RR3120FL X 32DP	

- Reversible for left or right installation
- Solid wood front
- Features 3/4" plywood finished to match cabinet box exterior on both sides
- Field trimmable, can be notched for toe kick

Floating Shelf

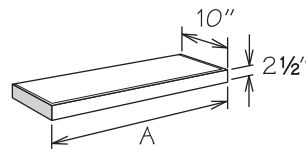

	A	Max. Load
FLSH2410	24"	30 lbs.
FLSH3010	30"	37 lbs.
FLSH3610	36"	45 lbs.
FLSH4210	42"	52 lbs.
FLSH4810	48"	60 lbs.

FLSH2410
FLSH3010
FLSH3610
FLSH4210
FLSH4810

- Not trimmable
- Finished on all sides to match cabinet box exterior
- Features veneered engineered wood top and bottom and solid wood front and sides
- When installed between two cabinets, Furniture Ends (FE) is recommended for adjacent cabinets
- Must be secured to studs in wall
- Installation instructions, mounting brackets and screws included

Finished Shelf

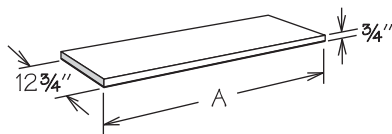

	A
FS4812	48 1/4"
FS6012	60 1/4"
FS7212	72 1/4"

FS4812
FS6012
FS7212

- Field trimmable
- Veneered engineered wood, edge banded all sides
- Finished to match cabinet box exterior

Finished Shelf
Duraform Textured

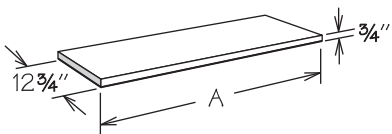

	A
FS4812 DT	48 1/4"
FS6012 DT	60 1/4"
FS7212 DT	72 1/4"

FS4812 DT
FS6012 DT
FS7212 DT

- Available for Breeze and Drift finishes only
- Field trimmable
- Features textured PVC-wrapped engineered wood finished on both sides to match cabinet door
- Edge banded on all sides

Blind Corner Closure

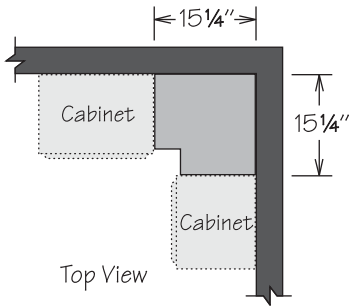
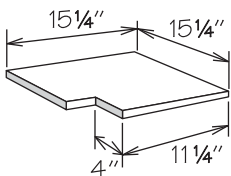

BLC1515

- Features 1/2" engineered wood with both sides finished with a natural woodgrain look
- Field trimmable

Toe Kicks

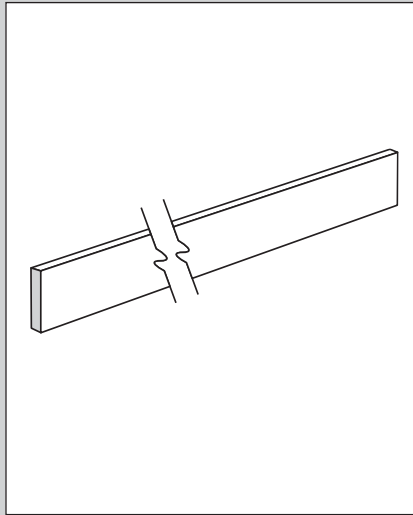

Base Toe Kick

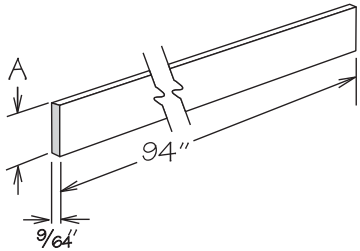

	A
BTK8	3 15/16"
BTK8 UD	8"

BTK8
BTK8 UD

- 94" long
- Features plywood or engineered wood finished on one side to match cabinet box exterior
- Putty Stick and TU Marker are recommended for exposed ends

Base Toe Kick
Duraform Textured

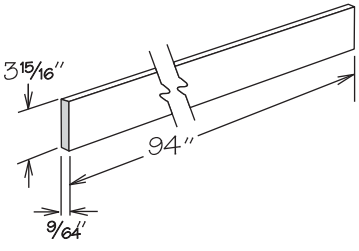

BTK8 DT

- 94" long
- Available for Breeze and Drift finishes only
- Features textured PVC-wrapped engineered wood finished on one side to match cabinet door
- Putty Stick and TU Marker are recommended for exposed ends

Decorator Matching Doors

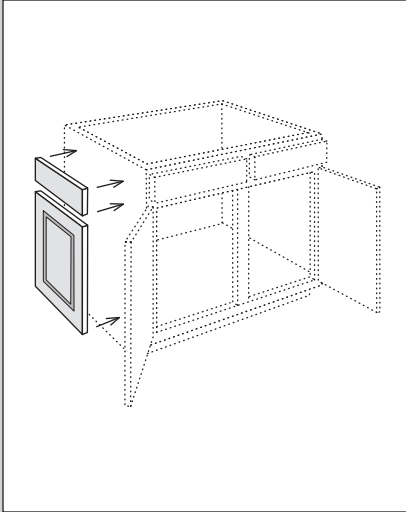

Decorator Matching Doors are not sized for Reduced Depth (RD) or Increased Depth (ID) cabinets.

Decorator Matching Doors

Tall Cabinets

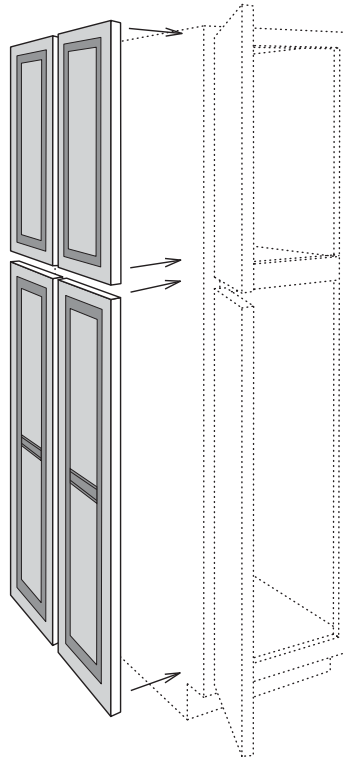

DMDT8412
DMDT8424
DMDT9012
DMDT9024
DMDT9312
DMDT9324
DMDT9612
DMDT9624

- Furniture Ends Option (FE) or TEP84/TEP96 panel is required for installation
- Attaches to side of Utility or Oven cabinet
- Matches style and finish of cabinet doors
- 24" deep features four doors (as shown)
- 12" deep features two doors
- Bottom doors have a center rail for select door styles - refer to door style section
- Refer to the Parts Directory section of this guide for dimensions

Decorator Matching Doors

Base Cabinets

NEW!

UPDATE

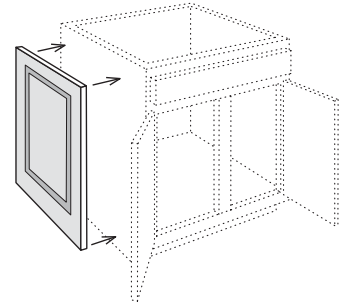

DMDB

- **UPDATE:** Full Overlay door styles use DR24FH
- Furniture Ends Option (FE) or BEP34 panel is required for installation
- Attaches to side of Base cabinet
- Matches style and finish of cabinet doors
- Refer to the Parts Directory section of this guide for dimensions

Decorator Matching Doors

BEA12FH Base Cabinets

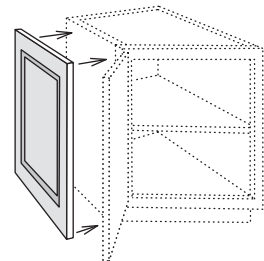

DMDBEA12

- Furniture Ends Option (FE) or WEP42 panel is required for installation
- Attaches to side of BEA12FH or BSPLY2434
- Matches style and finish of cabinet doors
- Refer to the Parts Directory section of this guide for dimensions

Decorator Matching Doors

Desk Cabinets

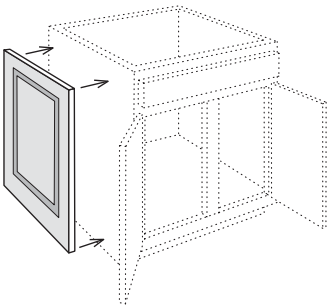

DMDD21
DMDD24

- Furniture Ends Option (FE) or BEP34 panel is required for installation
- Attaches to side of 21" or 24" deep Desk cabinet
- Matches style and finish of cabinet doors
- Refer to the Parts Directory section of this guide for dimensions

Decorator Matching Doors

Vanity Cabinets

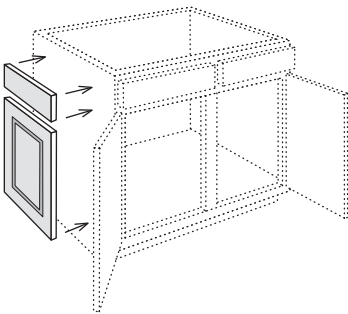

DMDV

- Furniture Ends Option (FE) or BEP34 panel is required for installation
- Attaches to side of 20 3/4" deep x 31 1/2" high Vanity cabinet
- For 18" deep x 31 1/2" high vanity cabinets order DR1821 ND and DDF18
- For base-height vanity cabinets order DR21FH ND door for 20 3/4" deep or DR18FH ND door for 18" deep cabinets
- Matches style and finish of cabinet doors
- Refer to the Parts Directory section of this guide for dimensions

Decorator Matching Doors

Wall Cabinets

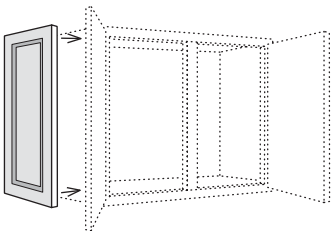

DMDW18
DMDW24
DMDW30
DMDW36
DMDW39
DMDW42

- Furniture Ends Option (FE) or WEP30/WEP42 panel is required for installation
- Attaches to side of wall cabinet
- Matches style and finish of cabinet doors
- Refer to the Parts Directory section of this guide for dimensions

Fillers



To facilitate proper door operation, include at least a 1" filler between the hinged side of Full Overlay door styles and deeper adjacent objects including cabinets, walls, appliances and countertops.

Universal Filler

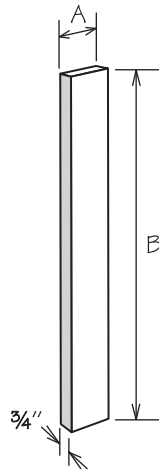

	A	B
UF3	3"	30 1/2"
UF6	6"	30 1/2"
UF342	3"	42 1/8"
UF642	6"	42 1/8"
UF380	3"	80"
UF680	6"	80"
UF392	3"	92"
UF692	6"	92"
UF3120	3"	120"
S3S396	3"	96"
S3S696	6"	96"
S4S396	3"	96"
S4S696	6"	96"

UF3	UF6
UF342	UF642
UF380	UF680
UF392	UF692
UF3120	S3S696
S3S396	S4S696
S4S396	

- 3/4" solid wood
- UF__ are finished on front, both long edges and one short end to match cabinet exterior
- S3S__ are finished on front and all four edges to match cabinet exterior
- S4S__ is finished on front, back and all four edges to match cabinet box exterior
- Field trimmable

Universal Filler Extension

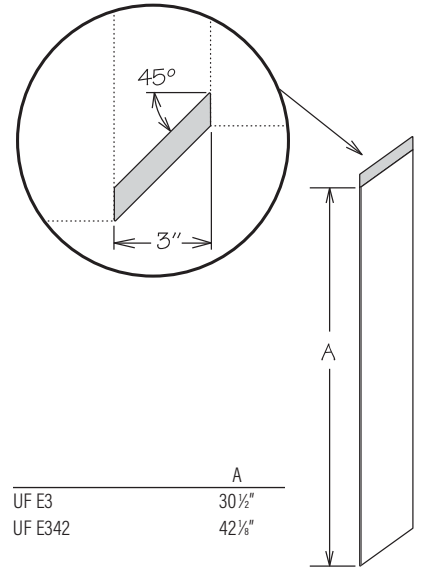

UF E3	30 1/2"
UF E342	42 1/8"

UF E3
UF E342

- For wall or base application
- 3/4" solid wood
- Finished on front, both long edges and one short end to match cabinet exterior
- Field trimmable

Base Corner Filler

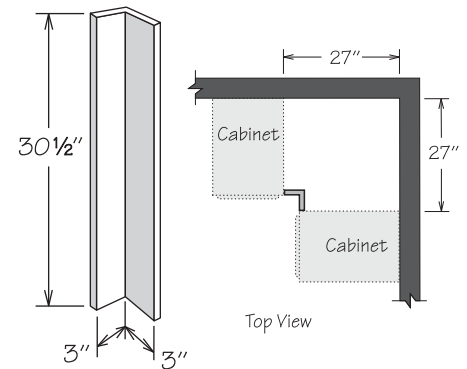

BCF27

- 3/4" solid wood
- Finished on front and all four edges to match cabinet box exterior
- Field trimmable

Overlay Filler

NEW! SIZE

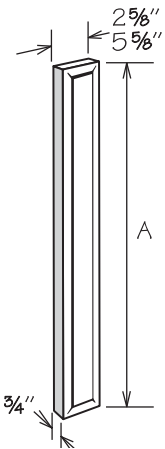

	A
BOF3	29 1/8"
BOF6	29 7/8"
DOF3	23 3/8"
TOF384	79 3/8"
TOF390	85 3/8"
TOF393	88 3/8"
TOF396	91 3/8"
VOF3	26 1/2"
WOF312	11 1/16"
WOF315	14 3/16"
WOF318	17 1/16"
WOF321	20"
WOF324	23 3/4"
WOF327	26 1/2"
WOF330	29 1/2"
WOF336	35 1/2"
WOF339	38 1/2"
WOF342	41 1/2"

BOF3	WOF312
BOF6	WOF315
DOF3	WOF318
	WOF321
TOF384	WOF324
TOF390	WOF327
TOF393	WOF330
TOF396	WOF336
	WOF339
VOF3	WOF342

- For Full Overlay door styles only
- Outside profile matches door
- Wood, Painted and Duraform (Breeze and Drift) door styles feature solid wood finished to match cabinet box exterior
- Duraform (Espresso, Harbor, Linen, Stone) door styles feature Duraform wrapped MDF
- All edges are finished
- Not field trimmable
- Must be mounted to a Universal Filler – order separately

Overlay Filler

Duraform Textured

NEW! SIZE

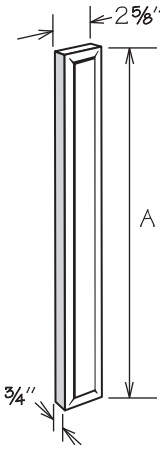

	A
BOF3 DT	29 1/8"
BOF6 DT	29 7/8"
DOF3 DT	23 3/8"
TOF384 DT	79 3/8"
TOF390 DT	85 3/8"
TOF393 DT	88 3/8"
TOF396 DT	91 3/8"
VOF3 DT	26 1/2"
WOF312 DT	11 1/16"
WOF315 DT	14 3/16"
WOF318 DT	17 1/16"
WOF321 DT	20"
WOF324 DT	23 3/4"
WOF327 DT	26 1/2"
WOF330 DT	29 1/2"
WOF336 DT	35 1/2"
WOF339 DT	38 1/2"
WOF342 DT	41 1/2"

BOF3 DT	WOF312 DT
BOF6 DT	WOF315 DT
DOF3 DT	WOF318 DT
	WOF321 DT
TOF384 DT	WOF324 DT
TOF390 DT	WOF327 DT
TOF393 DT	WOF330 DT
TOF396 DT	WOF336 DT
	WOF339 DT
VOF3 DT	WOF342 DT

- Available for Breeze and Drift finishes only
- Outside profile matches door
- Features textured PVC-wrapped engineered wood finished to match cabinet door
- All edges are finished
- Not field trimmable
- Must be mounted to a Universal Filler – order separately

Overlay Filler

Duraform

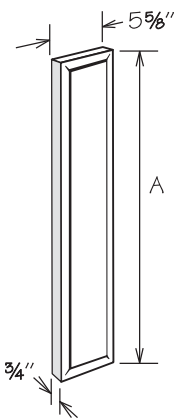

	A
WOF630	29 1/2"
WOF636	35 1/2"
WOF639	38 1/2"
WOF642	41 1/2"

WOF630
WOF636
WOF639
WOF642

- For Full Overlay Duraform (Espresso, Harbor, Linen, Stone) door styles only
- Outside profile matches door
- All edges are finished to match cabinet box exterior
- Features Duraform wrapped MDF
- Not field trimmable
- Must be mounted to a Universal Filler – order separately

Overlay Filler Profiles

Profile for:

- McKinley



Profile for:

- Irvington
- Irvington w/ DFO

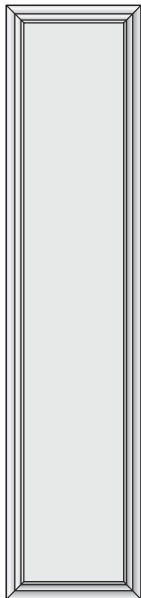

Profile for:

- Edgeworth*
- Edgeworth w/ DFO



*excluding Edgeworth Duraform

Profile for:

- Breckenridge
- Breckenridge w/ DFO
- Cottage
- Glasson
- Glasson w/ DFO
- Mission
- Mission w/ DFO
- Stemson
- Sydney
- Warren
- Warren w/ DFO

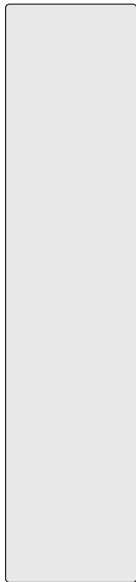

Profile for:

- Edgeworth Duraform



Fluted Beaded Filler
Reversible - 3" Wide

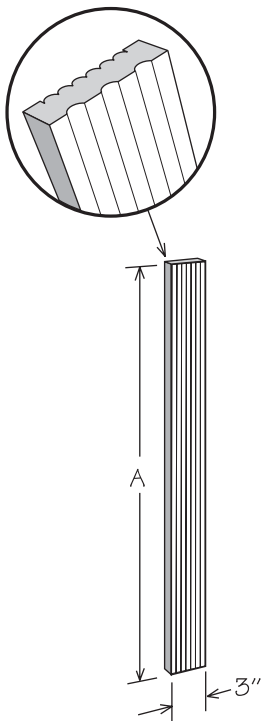

	A
FBF3	30½"
FBF342	42⅞"
FBF384	84"
FBF396	96"

FBF3
FBF342
FBF384
FBF396

- Filler is fluted on one side and beaded on reverse side
- Finished on all sides to match cabinet box exterior
- Field trimmable
- ¾" solid wood
- Apply 3" wide decorative blocks for accent
- Designer note: Ensure correct side is exposed when installed

Fluted Beaded Filler
Reversible - 6" Wide

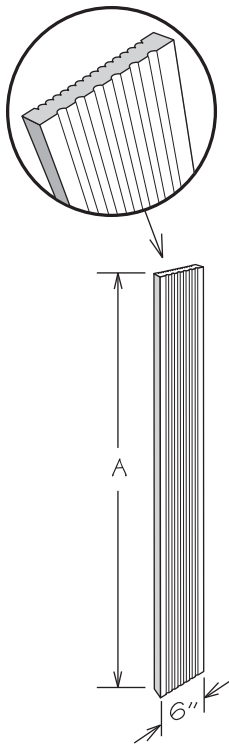

	A
FBF6	30½"
FBF642	42⅞"
FBF684	84"
FBF696	96"

FBF6
FBF642
FBF684
FBF696

- Filler is fluted on one side and beaded on reverse side
- Finished on all sides to match cabinet box exterior
- Field trimmable
- ¾" solid wood
- Apply 6" wide decorative blocks for accent
- Designer note: Ensure correct side is exposed when installed

Fluted Beaded Filler Extension
Reversible

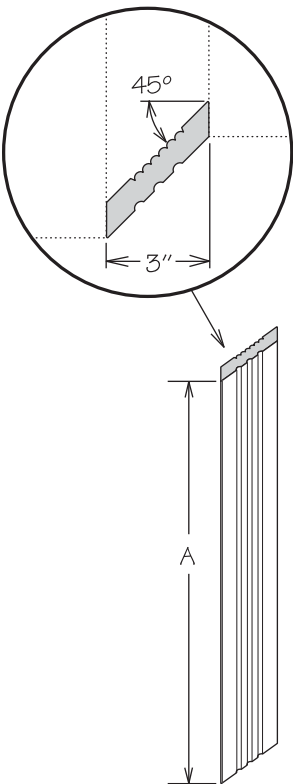

	A
FBF E3	30½"
FBF E342	42⅞"

FBF E3
FBF E342

- For wall or base application
- Filler is fluted on one side and beaded on reverse side
- Finished on all sides to match cabinet box exterior
- Field trimmable
- ¾" solid wood
- Apply 3" wide decorative blocks for accent
- Designer note: Ensure correct side is exposed when installed

Wall Column Filler

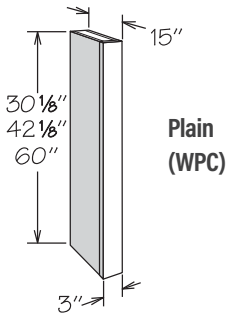
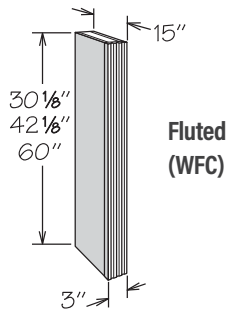
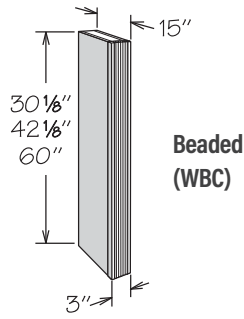

WBC31530
WBC31542
WBC31560
WFC31530
WFC31542
WFC31560
WPC31530
WPC31542
WPC31560

- 3" wide x 3/4" thick solid wood front
- Finished veneered engineered wood sides are flush with face
- Reversible for left or right installation
- Top and bottom edges of returns are edge banded to match cabinet box exterior
- Field trimmable to any depth
- Field trimmable in height as noted below:
 - W_C31530 field trimmable to 27", 24 1/2", 20 3/4", 18 1/2", 15" or 12 1/2"
 - W_C31542 field trimmable to 36 1/2" or 39 1/2"
 - W_C31560 field trimmable to 48" or 54"

Base Column Filler

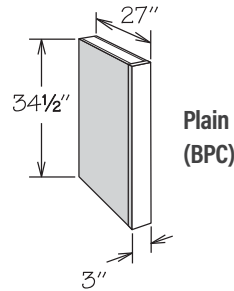
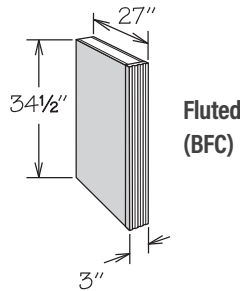
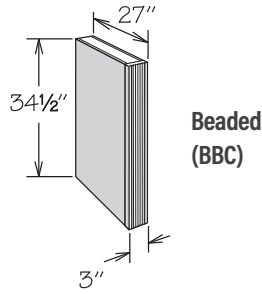

BBC32734
BFC32734
BPC32734

- 3" wide x 3/4" thick solid wood front
- Finished veneered engineered wood sides are flush with face
- Reversible for left or right installation
- Top and bottom edges of returns are edge banded to match cabinet box exterior
- Field trimmable to any depth
- Field trimmable in height as noted below:
 - B_C32734 field trimmable to 31 1/2" or 28 1/2"

Tall Column Filler

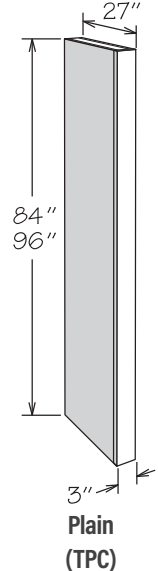
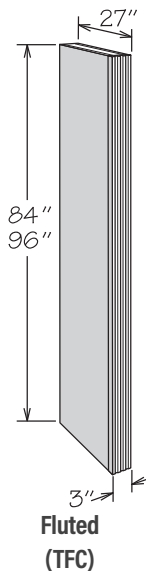
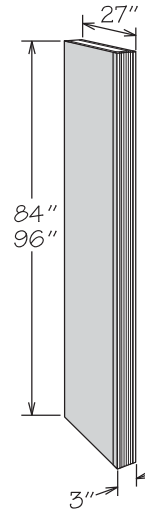

TBC32784
TBC32796
TFC32784
TFC32796
TPC32784
TPC32796

- 3" wide x 3/4" thick solid wood front
- Finished veneered engineered wood sides are flush with face
- Reversible for left or right installation
- Top and bottom edges of returns are edge banded to match cabinet box exterior
- Field trimmable to any depth
- Field trimmable in height as noted below:
 - T_C32796 field trimmable to 90" or 93"
 - T_C32784 is not field trimmable in height

Decorative Blocks

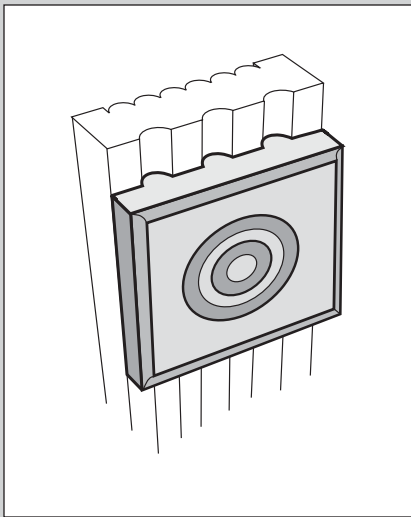

Rosette Block - 3" Fluted

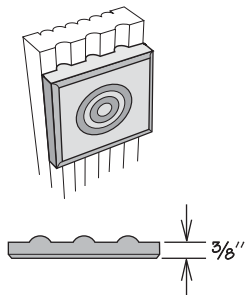
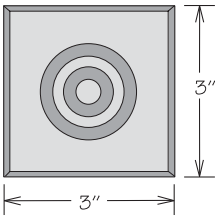

FB3X3 ROSETTE

- Apply to FLUTED side of 3" reversible filler, reversible filler extension or fluted column filler
- Solid wood finished to match cabinet box exterior

Rosette Block - 3" Beaded

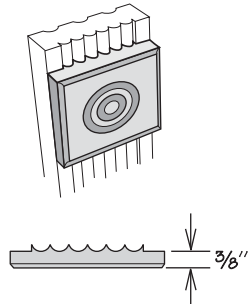
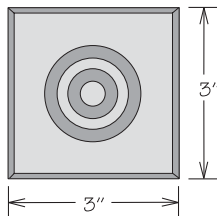

BB3X3 ROSETTE

- Apply to BEADED side of 3" reversible filler, reversible filler extension or beaded column filler
- Solid wood finished to match cabinet box exterior

Plinth Block - 3" Fluted

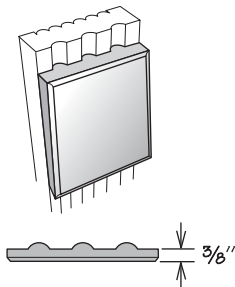
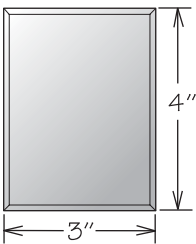

FB3X4 PLINTH

- Apply to FLUTED side of 3" reversible filler, reversible filler extension or fluted column filler
- Solid wood finished to match cabinet box exterior

Plinth Block - 6" Fluted

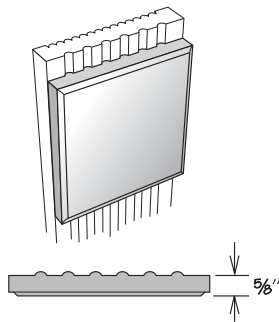
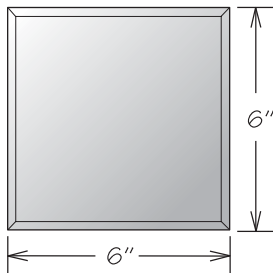

FB6X6 PLINTH

- Apply to FLUTED side of 6" reversible filler
- Solid wood finished to match cabinet box exterior

Valances

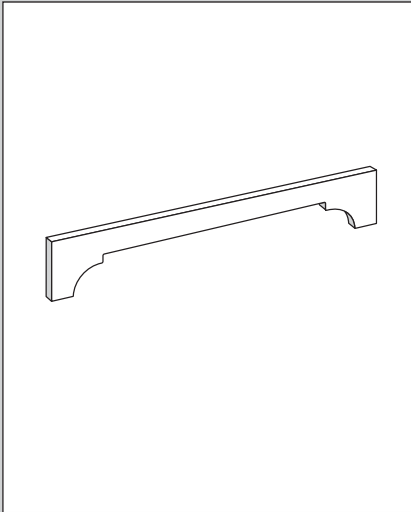

Raised Panel Arched Valance

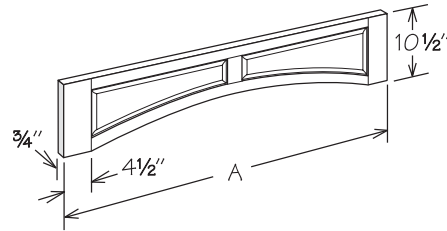

	A	Maximum Trim (3" Each End)	Number of Panels
V36 RP	36"	30"	2
V42 RP	42"	36"	2
V48 RP	48"	42"	2
V54 RP	54"	48"	3
V60 RP	60"	54"	3
V66 RP	66"	60"	3
V72 RP	72"	66"	3

V36 RP V60 RP
V42 RP V66 RP
V48 RP V72 RP
V54 RP

- Field trimmable
- Solid wood finished to match cabinet box exterior
- Dimension from height of arch to top of valance is 8 1/2"

Flat Panel Arched Valance

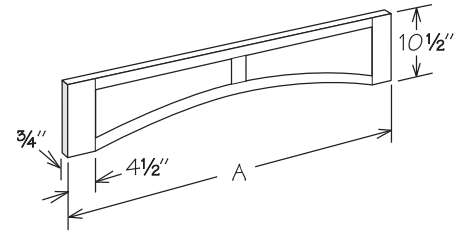

	A	Maximum Trim (3" Each End)	Number of Panels
V36 FP	36"	30"	2
V42 FP	42"	36"	2
V48 FP	48"	42"	2
V54 FP	54"	48"	3
V60 FP	60"	54"	3
V66 FP	66"	60"	3
V72 FP	72"	66"	3

V36 FP V60 FP
V42 FP V66 FP
V48 FP V72 FP
V54 FP

- Field trimmable
- Solid wood finished to match cabinet box exterior
- Dimension from height of arch to top of valance is 8 1/2"

Shaker Valance

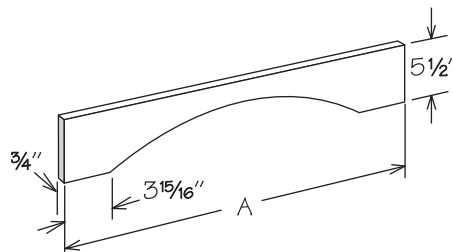

	A	Maximum Trim (3 1/2" each end)
V30 SH	30 1/4"	24"
V36 SH	36 1/4"	30"
V42 SH	42 1/4"	36"
V48 SH	48 1/4"	42"
V60 SH	60 1/4"	54"
V72 SH	72 1/4"	66"

V30 SH V48 SH
V36 SH V60 SH
V42 SH V72 SH

- Field trimmable
- Solid wood finished to match cabinet box exterior
- Dimension from height of arch to top of valance is 2 1/4"

Arched Valance

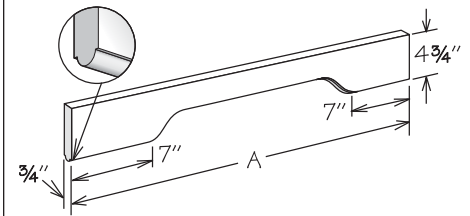

	A	Maximum Trim (6 1/2" each end)
V36 AR	36 1/4"	24"
V48 AR	48 1/4"	36"
V60 AR	60 1/4"	48"
V72 AR	72 1/4"	60"

V36 AR
V48 AR
V60 AR
V72 AR

- Field trimmable
- Solid wood finished to match cabinet box exterior
- Dimension from height of arch to top of valance is 2 1/2"

Crown Valance

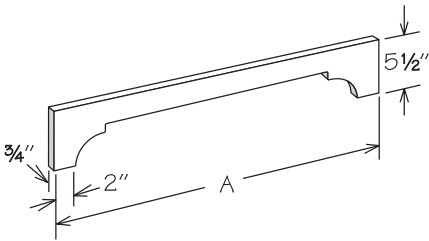

	A	Maximum Trim (1 1/2" each end)
V30 CR	30 1/4"	27 1/4"
V36 CR	36 1/4"	33 1/4"
V42 CR	42 1/4"	39 1/4"
V48 CR	48 1/4"	45 1/4"
V60 CR	60 1/4"	57 1/4"
V72 CR	72 1/4"	69 1/4"

V30 CR	V48 CR
V36 CR	V60 CR
V42 CR	V72 CR

- Field trimmable
- Solid wood finished to match cabinet box exterior
- Dimension from height of arch to top of valance is 2 1/4"

Straight Valance

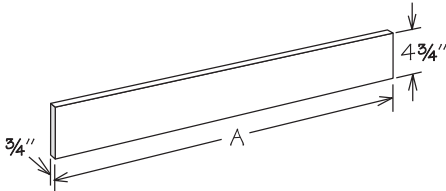

	A
V48 S	48 1/4"
V72 S	72 1/4"

V48 S
V72 S

- Field trimmable
- Solid wood finished to match cabinet box exterior

Traditional Valance

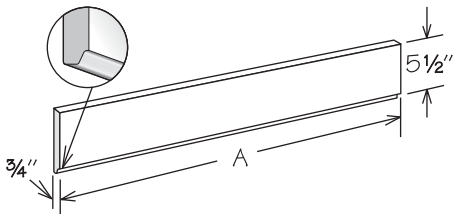

	A
V36 T	36 1/4"
V72 T	72 1/4"
V96 T	96 1/4"

V36 T
V72 T
V96 T

- Field trimmable
- Solid wood finished to match cabinet box exterior

Corbels

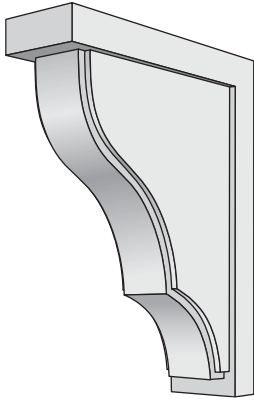

For decorative accessory designs, visit
Designer Resources
(<http://resources.shenandoahcabinetry.com/>).

Small Cove Corbel

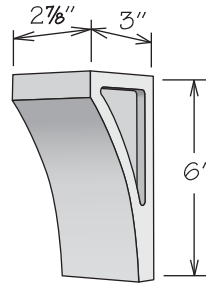

CC36

- Solid wood finished to match cabinet box exterior
- Recessed key hole brackets included
- For decorative use only

Medium Cove Corbel

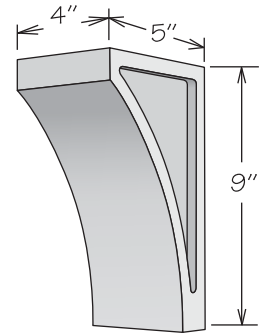

CC49

- Solid wood finished to match cabinet box exterior
- Recessed key hole brackets included
- For decorative use only

Small Narrow Cove Corbel

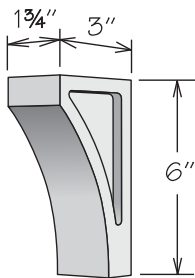

CC26

- Solid wood finished to match cabinet box exterior
- Recessed key hole brackets included
- For decorative use only

Medium Narrow Cove Corbel

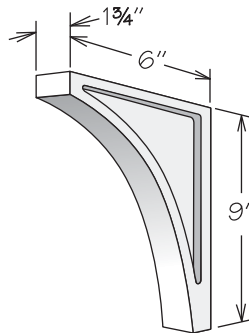

CC29

- Solid wood finished to match cabinet box exterior
- Recessed key hole brackets included
- For decorative use only

Large Narrow Cove Corbel

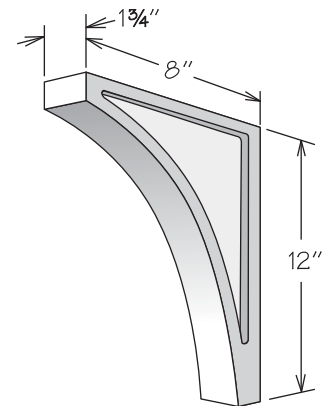

CC212

- Solid wood finished to match cabinet box exterior
- Recessed key hole brackets included
- For decorative use only

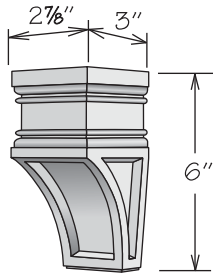
Small Valencia Corbel

VC36

- Solid wood finished to match cabinet box exterior
- Recessed key hole brackets included
- For decorative use only

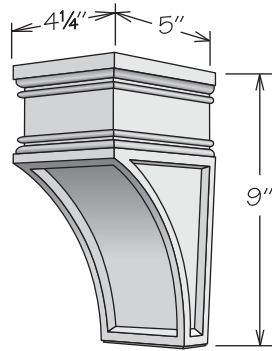
Medium Valencia Corbel

VC49

- Solid wood finished to match cabinet box exterior
- Recessed key hole brackets included
- For decorative use only

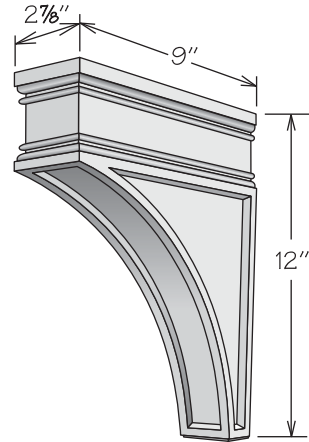
Large Valencia Corbel

VC312

- Solid wood finished to match cabinet box exterior
- Recessed key hole brackets included
- For decorative use only

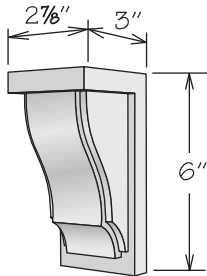
Small Finley Corbel

FC36

- Solid wood finished to match cabinet box exterior
- Recessed key hole brackets included
- For decorative use only

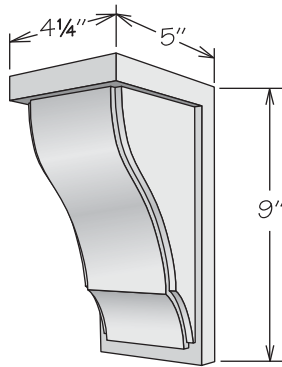
Medium Finley Corbel

FC49

- Solid wood finished to match cabinet box exterior
- Recessed key hole brackets included
- For decorative use only

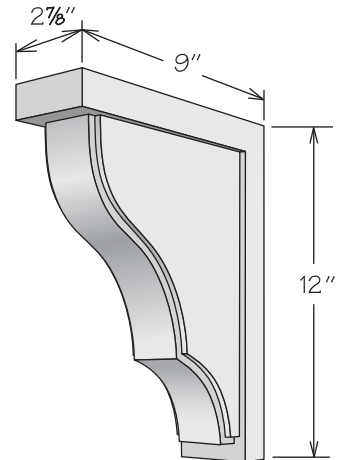
Large Finley Corbel

FC312

- Solid wood finished to match cabinet box exterior
- Recessed key hole brackets included
- For decorative use only

Small Prairie Corbel

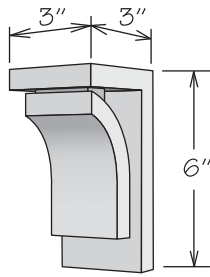

PC36

- Solid wood finished to match cabinet box exterior
- Recessed key hole brackets included
- For decorative use only

Medium Prairie Corbel

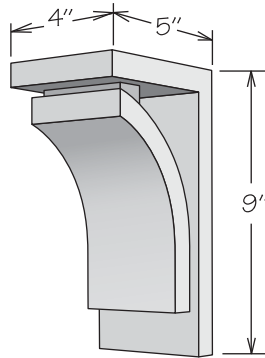

PC49

- Solid wood finished to match cabinet box exterior
- Recessed key hole brackets included
- For decorative use only

Large Prairie Corbel

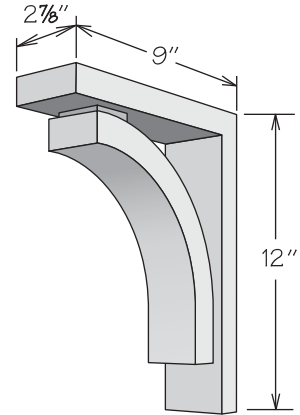

PC312

- Solid wood finished to match cabinet box exterior
- Recessed key hole brackets included
- For decorative use only

Small Rosette Corbel

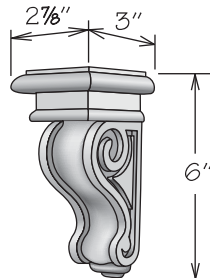

RC36

- Solid wood finished to match cabinet box exterior
- Recessed key hole brackets included
- For decorative use only

Medium Rosette Corbel

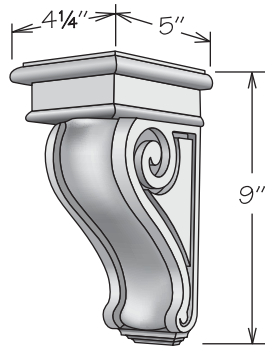

RC49

- Solid wood finished to match cabinet box exterior
- Recessed key hole brackets included
- For decorative use only

Large Rosette Corbel

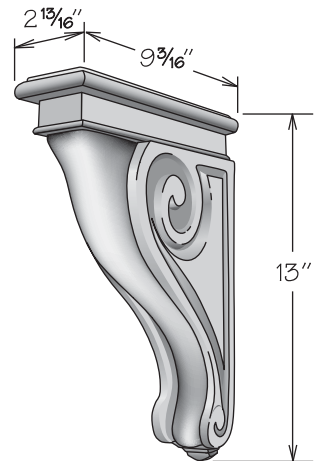

RC313

- Solid wood finished to match cabinet box exterior
- Recessed key hole brackets included
- For decorative use only

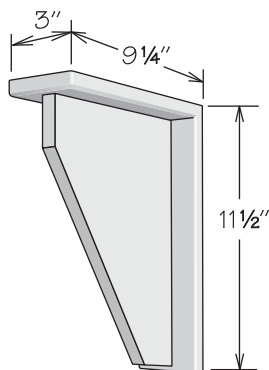
Angled Corbel

AS12

- Field installation accessory
- Decorative use only
- Features 5/8" solid wood finished to match cabinet box exterior

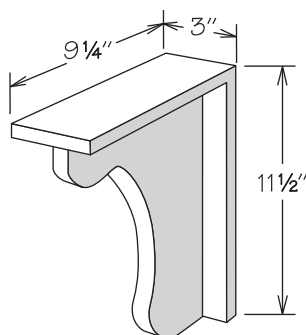
Curved Corbel

CS12

- Field installation accessory
- Decorative use only
- Features 5/8" solid wood finished to match cabinet box exterior

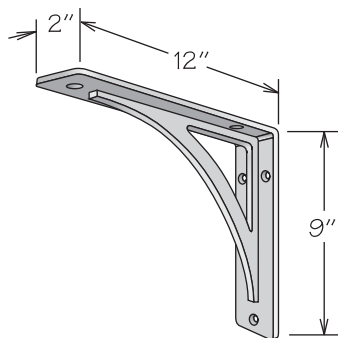
Metal Cove Corbel

METAL COVE 212 VB
METAL COVE 212 MB
METAL COVE 212 SN
METAL COVE 212 PC

- Weight capacity is 100lbs when installed per included installation instructions
- Installation hardware included
- Available in four metal finishes
 - VB - Verona Bronze
 - MB - Matte Black
 - SN - Satin Nickel
 - PC - Polished Chrome
- Can be installed using either height orientation

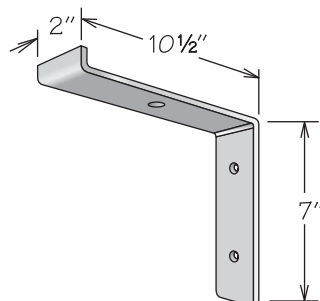
Metal Emerson Corbel

METAL EMERSON 27 VB
METAL EMERSON 27 MB
METAL EMERSON 27 SN
METAL EMERSON 27 PC

- Weight capacity is 100lbs when installed per included installation instructions
- Installation hardware included
- Available in four metal finishes
 - VB - Verona Bronze
 - MB - Matte Black
 - SN - Satin Nickel
 - PC - Polished Chrome
- Can be used with floating shelf

Legs, Feet & Posts

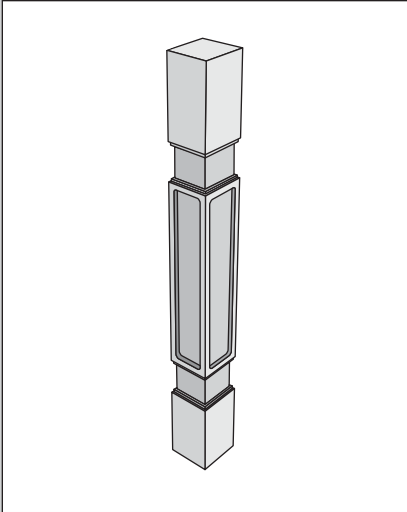

Base Tapered Leg

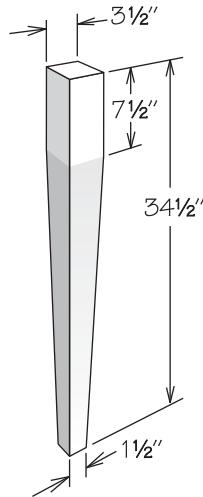

BTPL

- Features solid wood finished to match cabinet box exterior
- Tapered on all sides
- Field trimmable

Tapered Foot

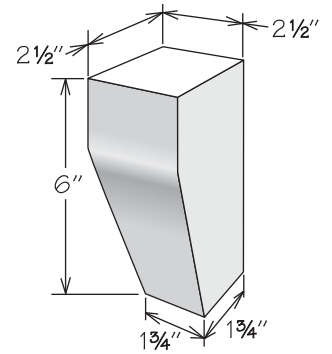

TPF

- Features solid wood finished to match cabinet box exterior
- Tapered on two sides
- Field trimmable to 4" high

Base Square Leg

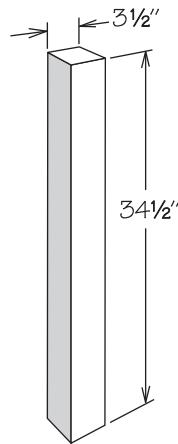

BSQL

- Features solid wood finished to match cabinet box exterior
- Field trimmable

Base Square Foot

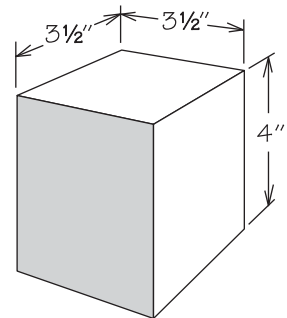

BSQF

- Features solid wood finished to match cabinet box exterior
- Designed as toe kick accent

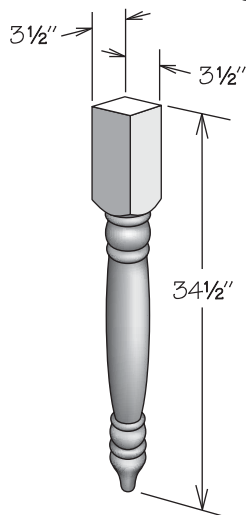
Base Turned Leg

BTL

- Features solid wood finished to match cabinet box exterior
- Field trimmable to 28 1/2" high

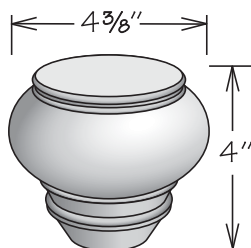
Accent Turned Foot
Full Round

ATF-FR

- Features solid wood finished to match cabinet box exterior
- Designed as toe kick accent

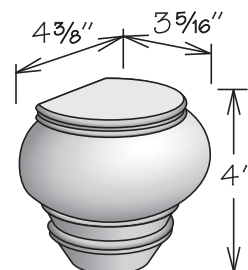
Accent Turned Foot

ATF

- Features solid wood finished to match cabinet box exterior
- Designed as toe kick accent

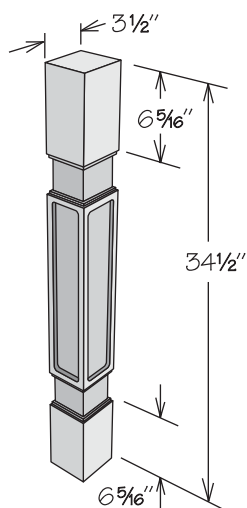
Parker Decorative Leg

PDL

- Features solid wood finished to match cabinet box exterior
- Field trimmable

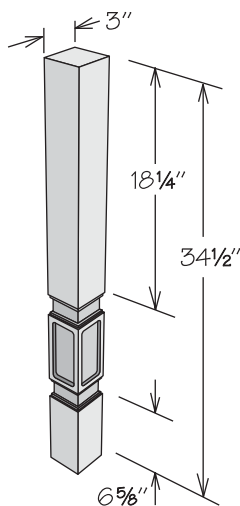
Parker Furniture Leg

PFL

- Features solid wood finished to match cabinet box exterior
- Field trimmable

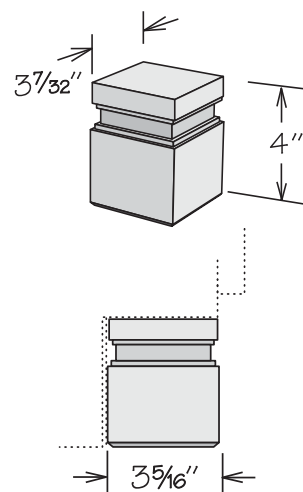
Parker Decorative Foot

PDF

- Features solid wood finished to match cabinet box exterior
- Designed as toe kick accent

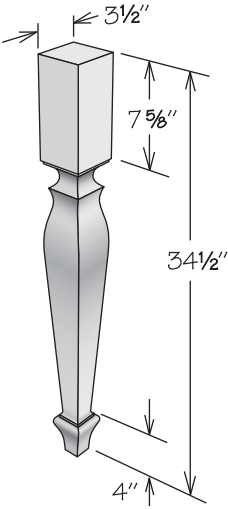
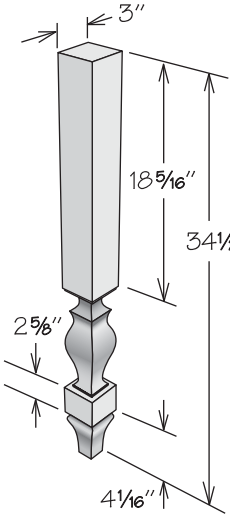
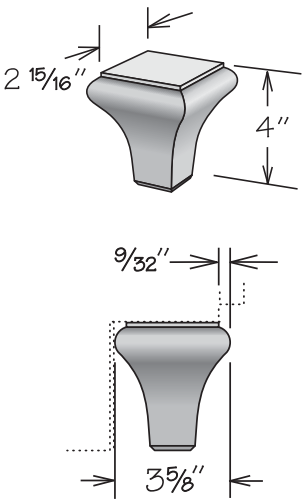
<div>Chantilly Decorative Leg</div> <div></div> <div>CDL</div> <div><ul style="list-style-type: none">• Features solid wood finished to match cabinet box exterior• Field trimmable</div>	<div>Chantilly Furniture Leg</div> <div></div> <div>CFL</div> <div><ul style="list-style-type: none">• Features solid wood finished to match cabinet box exterior• Field trimmable</div>	<div>Chantilly Decorative Foot</div> <div></div> <div>CDF</div> <div><ul style="list-style-type: none">• Features solid wood finished to match cabinet box exterior• Designed as toe kick accent</div>
---	--	--

Split Post

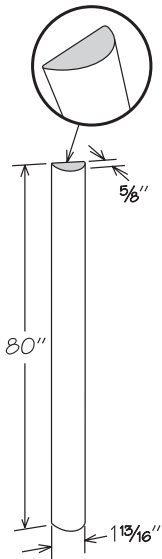

SPLT POST80 P

- Features solid wood finished to match cabinet box exterior
- Field trimmable
- Use with Traditional Split Blocks to create design element
- Must be mounted to a Universal Filler – order separately

Traditional Split Block - 6"

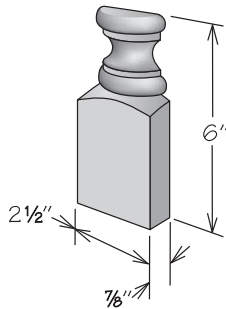

SPLT BLOCK26 T

- Features solid wood finished to match cabinet box exterior
- For floor or wall application
- Must be mounted to a Universal Filler – order separately

Suggested Design Applications

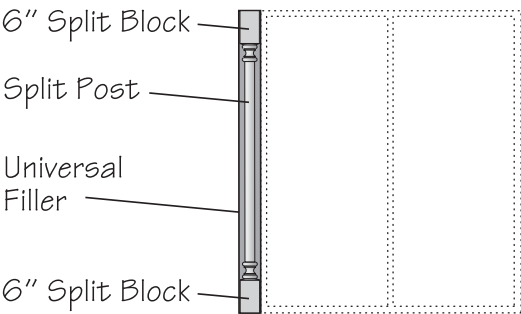

Wall Cabinet

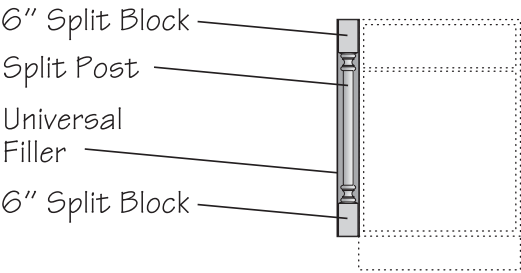

Base Cabinet

PANELS, FILLERS & DECORATIVE ITEMS

Installation Items

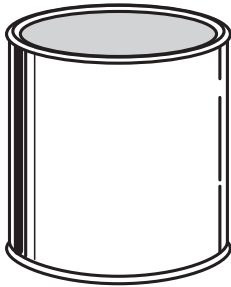

Screws & Screw Cover Caps

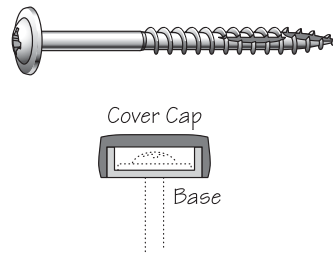

SCREW INST 2.5 BX100
(Box of 100)

COVER CAP TAN
COVER CAP WHT
(Bag of 50)

- Installation screws are Phillips pan head with attached washer 2½" long
- Cover caps used to conceal head of installation screw

Shelf Rests

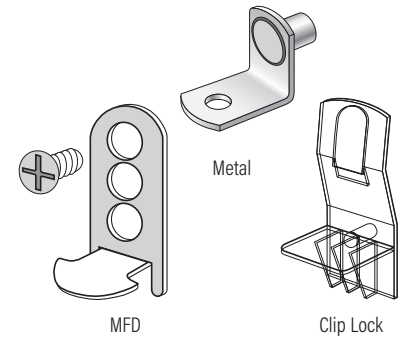

SHELF REST METAL 4PK
(Package of 4 - Wall cabinets, OFD cabinets or Bookshelves)

SHELF REST METAL 12
(Package of 12 - Wall cabinets, OFD cabinets or Bookshelves)

SHELF REST MFD PK
(Package of 8 - MFD cabinets)

CLIP LOCK 3/4 4 PK
(Package of 4 - Base or Tall cabinets)

- Metal and MFD shelf rests are nickel-plated steel
- MFD shelf rests are six-position adjustable for alignment of shelf with mullion
- Clip Lock shelf rests are molded clear high-strength polycarbonate

Dummy Drawer Front Fastener

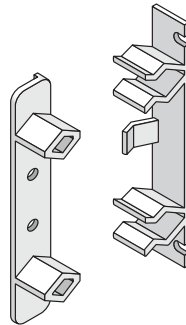

DDF FASTENER

- For installation of one dummy drawer front
- Kit features:
 - Two sets of DDF Fasteners
 - Eight screws
 - One Instruction Sheet
- Please refer to cabinet specifications as some cabinets will require more than one kit

CushionClose Door Buffer

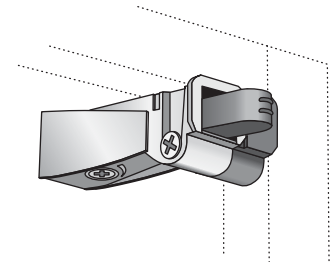

CUSH CLOSE DR BUFFER

- Field installation accessory
- Slow closing system helps reduce slams and noise
- Package includes one unit and installation instructions
- Pre-drilling of face frames recommended
- One unit per door recommended for doors up to 30" high
- Two units per door recommended for doors 36" and higher
- Not for use on the following SKUs: BEA12 FH, BER, BFP3, BFP6, BPP9, BPP12, BPPUS9, BPPUS12, BSS, BTDP9, BWBB, CAR, DFDC, DWBB, VWBB, WEA, WER or WTH

Cleat

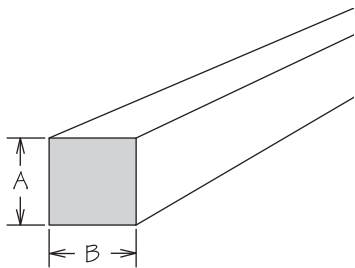

	A	B	Length
HWC 1/2X1/2X94	1/2"	1/2"	94"
HWC 3/4X3/4X94	3/4"	3/4"	94"
HWC 1X2X94	3/4"	1 1/2"	94"
HWC 2X4X96	1 1/2"	3 1/2"	96"

HWC 1/2X1/2X94
HWC 3/4X3/4X94
HWC 1X2X94
HWC 2X4X96

- HWC 1/2X1/2X94 and HWC 3/4X3/4X94 are shipped in two 47" long pieces
- Unfinished

Stain

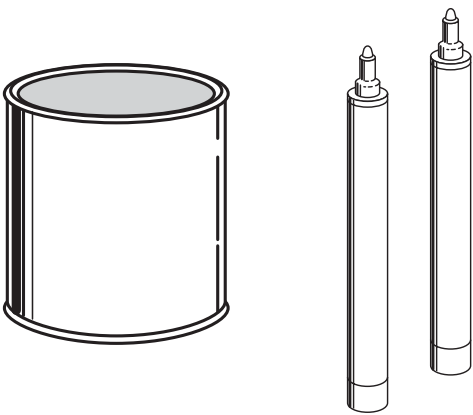

STAIN PINT
STAIN QUART
STAIN GLAZED PINT
STAIN GLAZED QUART
STAIN GLAZED PENS
STAIN TOP COAT PINT
STAIN TOP COAT QUART

- STAIN PINT (QUART) for use on all non-glazed stains and non-glazed painted finishes
- STAIN GLAZED PINT (QUART) for use on all glazed stains and glazed painted finishes
- STAIN TOP COAT strongly recommended for application over ALL finishes – order separately
- STAIN GLAZED includes STAIN PINT and two STAIN GLAZED PENS per pint
- STAIN GLAZED PENS available for order separately (quantity of two)
- Stains for Duraform Breeze and Drift will match the cabinet box exterior
- Indicate species and finish when ordering
- PINT covers approximately 40 square feet
- QUART covers approximately 80 square feet
- Instructions included
- Glaze comes as pens only - not cans

Spray Stain

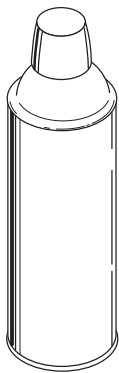

SPRAY STAIN CLEAR
SPRAY STAIN TINTED

- SPRAY STAIN TINTED available for all finishes (excluding Maple Truffle, Spice, Cognac and Cherry Java)
- SPRAY STAIN CLEAR for use as top coat for all finishes
- SPRAY STAIN TINTED for Duraform Breeze and Drift will match the cabinet box exterior
- Indicate species and finish when ordering
- 11-ounce aerosol spray can

Hinge Restrictor Clip

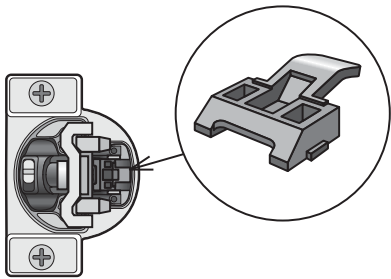

HINGE CC ANG RES CLP

- Limits door opening to 86 degrees to avoid contact with adjacent objects
- For use on CushionClose hinges only
- Package includes 10 per bag (1 required per hinge)

Edge Banding
Duraform Textured

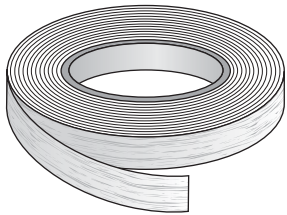

	Height	Length
EDGE BAND 25 DT	7/8"	25 feet
EDGE BAND TAPE 50	1"	50 feet

EDGE BAND 25 DT
EDGE BAND TAPE 50

- Available for Breeze and Drift finishes only
- Field trimmable
- Tape must be ordered with edge banding for installation

Putty Stick & Marker

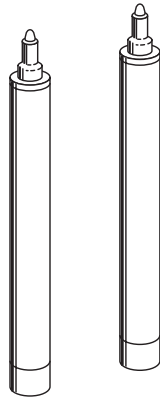

PUTTY STICK EXT QTY1
PUTTY STICK EXT QTY2
PUTTY STICK INTERIOR

TU MARKER DURAFORM
TU MARKER EXT QTY1
TU MARKER EXT QTY2
TU MARKER INTERIOR

- Indicate species and finish when ordering
- Refer to chart to order correct QTY
- Putty Stick – for filling minor dents, gouges and scratches made during or after installation
- Touch Up Marker – adds color to minor surface scratches
- Touch Up Markers & Putty Sticks for Duraform Breeze and Drift will match the cabinet box exterior

Finish	Putty Stick	TU Marker
Cherry Java	PUTTY STICK EXT QTY1	TU MARKER EXT QTY1
Cherry Slate	PUTTY STICK EXT QTY1	TU MARKER EXT QTY1
Duraform Breeze	PUTTY STICK EXT QTY1	TU MARKER EXT QTY2
Duraform Drift	PUTTY STICK EXT QTY1	TU MARKER EXT QTY1
Duraform Espresso	PUTTY STICK EXT QTY1	TU MARKER DURAFORM
Duraform Harbor	PUTTY STICK EXT QTY1	TU MARKER DURAFORM
Duraform Linen	PUTTY STICK EXT QTY2	TU MARKER DURAFORM
Duraform Stone	PUTTY STICK EXT QTY1	TU MARKER DURAFORM
Maple Cognac	PUTTY STICK EXT QTY1	TU MARKER EXT QTY1
Maple Latte	PUTTY STICK EXT QTY1	TU MARKER EXT QTY1
Maple Rye	PUTTY STICK EXT QTY1	TU MARKER EXT QTY1
Maple Slate	PUTTY STICK EXT QTY1	TU MARKER EXT QTY1
Maple Spice	PUTTY STICK EXT QTY1	TU MARKER EXT QTY1
Maple Truffle	PUTTY STICK EXT QTY1	TU MARKER EXT QTY2
Painted Black	PUTTY STICK EXT QTY1	TU MARKER EXT QTY1
Painted Biscotti	PUTTY STICK EXT QTY1	TU MARKER EXT QTY2
Painted Boulder	PUTTY STICK EXT QTY1	TU MARKER EXT QTY1
Painted Ember	PUTTY STICK EXT QTY1	TU MARKER EXT QTY2
Painted Harbor	PUTTY STICK EXT QTY1	TU MARKER EXT QTY1
Painted Linen	PUTTY STICK EXT QTY2	TU MARKER EXT QTY2
Painted Navy	PUTTY STICK EXT QTY1	TU MARKER EXT QTY1
Painted Pewter	PUTTY STICK EXT QTY1	TU MARKER EXT QTY2
Painted Sage	PUTTY STICK EXT QTY1	TU MARKER EXT QTY1
Painted Stone	PUTTY STICK EXT QTY1	TU MARKER EXT QTY1
Painted Vanilla	PUTTY STICK EXT QTY1	TU MARKER EXT QTY1
Interior	PUTTY STICK INTERIOR	TU MARKER INTERIOR